

# CERTIFIED CORNER RECORDATION

Corner NW 1/16 S1 T. 31 N. R. 31 W. P.M.M. Lincoln County

I. Record: None

II. Found: No record monuments found.

III. Perpetuation: At the corner point, determined by survey, set a 5/8 ins. diam. steel rebar 30 ins. long, 29 ins. in the ground, with a 3 1/4 ins. diam. Aluminum cap marked as shown below from which:

A Douglas fir 12 ins. diam., bears S36°W, 15.60 ft. dist., scribed NW 1/16 S1 BT.

A Douglas fir, 14 ins. diam., bears N85°W, 33.60 ft. dist., scribed NW 1/16 S1 BT.

Painted faces and 6 in. wide red bands to all bearing trees and attached Land Survey Monument and Bearing Tree signs.

Magnetic declination: 18° East

Equipment used: Hand compass and loggers tape

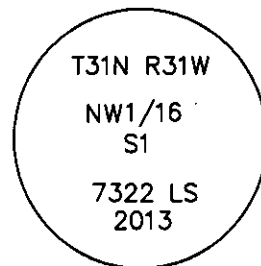

NOTE: Refer to Certificate of Survey No. \_\_\_\_\_ Lincoln County Records for additional survey information.

Kootenai Surveyors Inc., 314 California Av., Libby, MT. 59923 (406) 293-4354

Sighting -Sec. 1

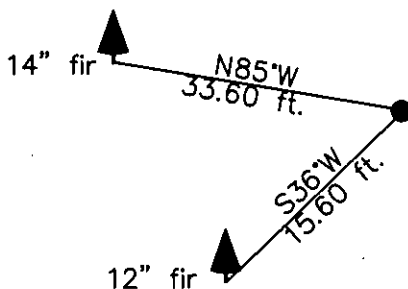

SKETCH OF CORNER

## CERTIFICATION

I, Kelly Ronney  
certify the information shown herein is true and correct.

Kelly Ronney  
Signature Ground Party Chief

I, Alvah F. Hughes  
certify that this Corner Record correctly represents work performed by me or under my direction in compliance with the "Corner Recordation Act" (70-22-101, et seq. M.C.A.)

Alvah F. Hughes  
Signature of Surveyor & Seal

Date: 04/1/2013 Reg. No. 7322LS

Employer: Kootenai Surveyors Inc.

Office of Clerk and Recorder, County of Lincoln This "corner

record" was filed for re: 244969 BOOK: CCR CC&R'S PAGE: 12025 Pages: 1

was noted on the cross: STATE OF MONTANA LINCOLN COUNTY  
RECORDED: 05/06/2013 1:50 KOI: CC&R'S

book No. TAMMY D. LAUER CLERK AND RECORDER

FEE: \$0.00

BY: Francis Stearns Deputy

FOR: KOOTENAI SURVEYORS INC. P.O. BOX 393, LIBBY, MT 59923

Cross Index No. B-22 T. 31N R. 31W P.M., MT

Adopted July 1, 1981, Montana Board of Professional Engineers & Land Surveyors

Sec. 1

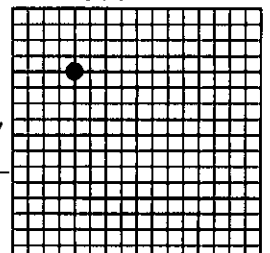

• corner this sheet