

CERTIFIED CORNER RECORDATION

Corner CE 1/16 S30 T. 31 N. R. 31 W. P.M.M. Lincoln County

I. Record: None

II. Found: No record monuments found.

III. Perpetuation: At the corner point, determined by survey, set a 5/8 ins. diam. steel rebar 30 ins. long, 29 ins. in the ground, with a 3 1/4 ins. diam. Aluminum cap marked as shown below from which:

A Douglas fir, 9 ins. diam., bears S15° E, 52.45 ft. dist., scribed CE 1/16 S30 BT.

A Douglas fir, 20 ins. diam., bears S7°W, 38.40 ft. dist., scribed CE 1/16 S30 BT.

Painted faces and 6 in. wide red bands to all bearing trees and attached Land Survey Monument and Bearing Tree signs.

Set a steel fence post along side set monument.

Magnetic declination: 18° East

Equipment used: Hand compass and loggers tape

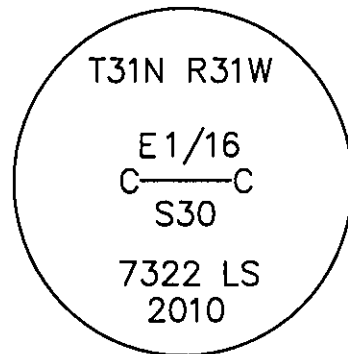

Kootenai Surveyors Inc., 314 California Av., Libby, MT. 59923 (406) 293-4354

NOBLE Sec. 30

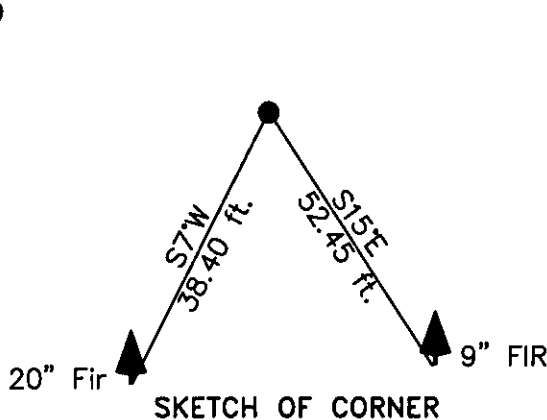

CERTIFICATION

I, Kelly Rooney
certify the information shown herein is true and correct.

Kelly Rooney
Signature Ground Party Chief

I, Alvah F. Hughes
certify that this Corner Record correctly represents work performed by me or under my direction in compliance with the "Corner Recordation Act" (70-22-101, et seq., M.C.A.)

Alvah F. Hughes
Signature of Surveyor & Seal

Date: 01/14/2010 Reg. No. 7322LS

Employer: Kootenai Surveyors Inc.

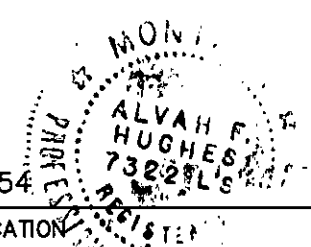

Office of Clerk and Recorder, County of Lincoln This "corner

record" was filed for record on 224497 BOOK: CCR CC&R'S PAGE: 11445 Pages: 1

was noted on the cross-index STATE OF MONTANA LINCOLN COUNTY

book No. RECORDED: 02/12/2010 3:25 KOI: CC&R'S

TAMMY D. LAUER CLERK AND RECORDER

FEE: \$0.00

TO: KOOTENAI SURVEYORS INC. P.O. BOX 393, LIBBY, MT 59923

Cross Index No. T 04 J. 31N R. 31W P.M., MT

Adopted July 1, 1981, Montana Board of Professional Engineers & Land Surveyors

Sec. 30

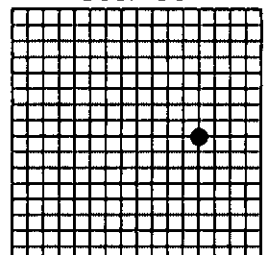

• corner this sheet