

CERTIFIED CORNER RECORDATION

Corner C 1/4 S30 T. 31 N. R. 31 W. P.M.M. Lincoln County

I. Record: None

II. Found: No record monuments found.

III. Perpetuation: At the corner point, determined by survey, set a 2 1/2 ins. diam.
Aluminum pipe 30 ins. long, 26 ins. in the ground, with a 3 1/4 ins. diam.
Aluminum cap marked as shown below from which:

A Douglas fir, 9 ins. diam., bears S4°E, 4.05 ft. dist., scribed C 1/4 S30 BT.

A Larch, 13 ins. diam., bears N33°E, 5.70 ft. dist., scribed C 1/4 S30 BT.

Painted faces and 6 in. wide red bands to all bearing trees and attached Land Survey Monument and Bearing Tree signs.

Set a steel fence post along side set monument.

Magnetic declination: 18° East

Equipment used: Hand compass and loggers tape

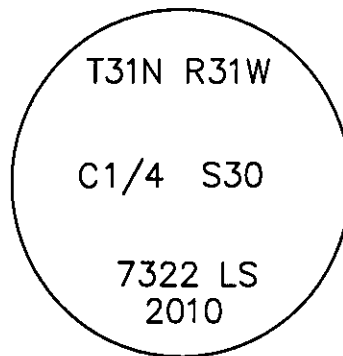

Kootenai Surveyors Inc., 314 California Av., Libby, MT. 59923 (406) 293-4354

NOBLE Sec. 30

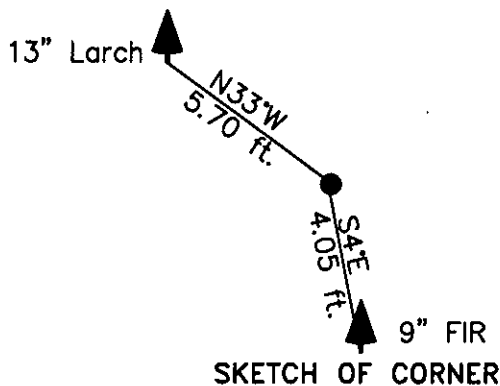

CERTIFICATION

I, Kelly Rooney
certify the information shown herein is true and correct.

Kelly Rooney
Signature Ground Party Chief

I, Alvah F. Hughes
certify that this Corner Record correctly represents work performed by me or under my direction in compliance with the "Corner Recordation Act" (70-22-101, et seq., M.C.A.)

Alvah F. Hughes
Signature of Surveyor & Seal

Date: 01/14/2010 Reg. No. 7322LS

Employer: Kootenai Surveyors Inc.

Office of Clerk and Recorder, County of Lincoln This "corner

record" was filed for record on _____

was noted on the cross-index

book No. _____

224495 BOOK: CCR CC&R'S PAGE: 11443 Pages: 1
STATE OF MONTANA LINCOLN COUNTY
RECORDED: 02/12/2010 3:15 KOI: CC&R'S
TAMMY D. LAUER CLERK AND RECORDER
FEE: \$0.00 BY: Tammy D. Lauer
TO: KOOTENAI SURVEYORS INC. P.O. BOX 393, LIBBY, MT 59923

Cross Index No. T 04 T. 31N R. 31W P.M., MT

Adopted July 1, 1981, Montana Board of Professional Engineers & Land Surveyors

Sec. 30

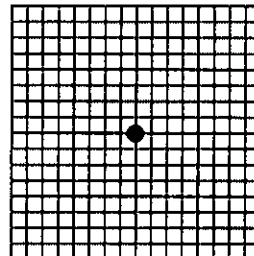

• corner this sheet