

INSTRUCTIONS

1. Original and/or subsequent record used to evaluate the corner position.
2. Description of evidence found, note discrepancies in the record, state method of establishing lost or obliterated corners.
3. Description of monument and accessories set to perpetuate the corner position.
4. Sketch of corner, show all pertinent data which can best be shown in a sketch example, corner marking, topography ties, position of accessories, etc.
5. Certification must be signed and sealed by Land Surveyor registered in the State of Montana.
6. Fill in Cross Index & Section Diagram at bottom of sheet.

CERTIFIED CORNER RECORDATION

Corner ¼ Cor. Sec. 13/18 T. 31 North R. 31 & 32 West P.M.M. Lincoln County

ORIGINAL – A. Jaqueth - 1901

Set a sandstone 16x14x5 inches, 11" in the ground, for ¼ Section Corner marked ¼ on West face; from which:

A Yellow Pine, 28" diameter, bears N10°E, 84 links (55.44') distant, marked ¼ S 18 BT.

A Yellow Pine, 24" diameter, bears N71°30'W, 89 links (58.74') distant, marked ¼ S13 BT.

FOUND:

Original stone 16x10x5 inches in place with ¼ on West face.

A 36" pine on ground with visible scribing bears N08°E, 122.18 feet distant.

A 39" pine with visible scribing bears N72°W, 57.09 feet distant.

ESTABLISH:

Replace original found stone with 3¼" standard aluminum monument marked as shown below. Buried original stone along side monument and place rock cairn around monument.

An 11" Douglas Fir bears S7°E, 10.99 feet distant, blaze and scribe ¼ S18 BT.

Paint bearing trees with red paint and attach bearing tree tags.

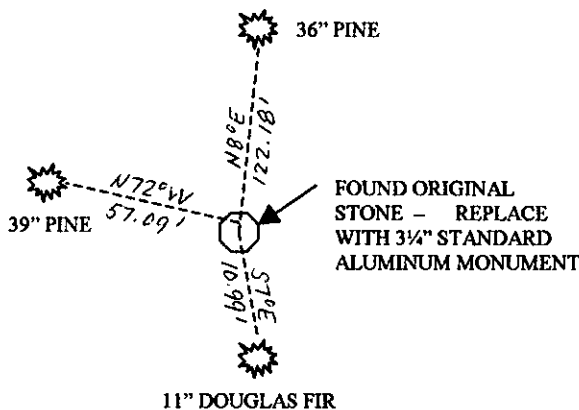
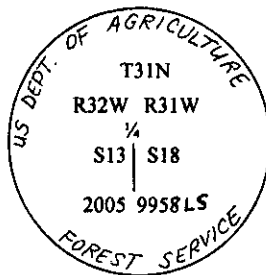

SKETCH OF CORNER

CERTIFICATION

I, James R. Staples

Certify the information shown herein is true and correct.

James R. Staples
Signature Ground Party Chief

I, James R. Staples

certify that this Corner Record correctly represents work performed by me or under my direction in compliance with the "Corner Recordation Act" (70-22-101, et seq., M.C.A.)

James R. Staples
Signature of Surveyor & Seal

Date: 7/4/05 Reg. No. 9958 LS

Employer: J.R.S. Surveying, Inc.

Office of Clerk and Recorder County of

185530 BOOK: CCR CC&R'S

This "corner

PAGE: 10794 Pages: 1

record" was filed for rec

STATE OF MONTANA LINCOLN COUNTY

was noted on the cross-i

RECORDED: 06/28/2005 10:00 KOI: CC&R'S

book no. _____

CORAL M. CUMMINGS CLERK AND RECORDER

FEE: \$0.00

BY: Deanne Dennis

TO: FILED

County Official

Cross Index No. L25 T. 31N R. 32W PMM

Adopted July 1, 1981, Montana Board of Professional Engineers & Land Surveyors

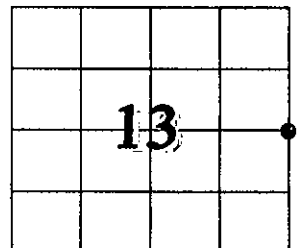

• - Corner this sheet