

# CERTIFIED CORNER RECORDATION

Corner C-W-E 1/64 Sec. 34 T. 31 N., R. 31 W., P.M.M. Lincoln County

Record :

Found Evidence :

## Perpetuation :

Set a 5/8 inch by 24 inch rebar with a 3 1/4 inch aluminum cap stamped: (See diagram below) 23 inches in the ground from which:

A 14 inch DBH Ponderosa pine bears N 9° E 44.8 ft. dist. scribed C-W-E 1/64 S 34 BT.

From which:

A 10 inch DBH Ponderosa pine bears N 81° E 14.6 ft. dist. scribed C-W-E 1/64 S 34 BT.

Painted 6 inch wide red bands and attached warning and bearing tree signs to both trees.

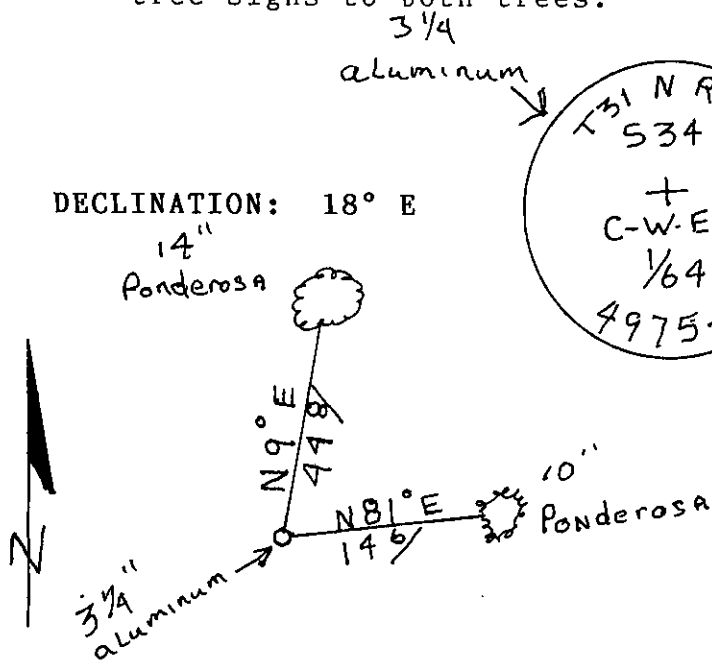

DECLINATION: 18° E

C-W-E 1/64 S 34 BT  
C-W-E 1/64 S 34 BT

## CERTIFICATION

I, George Clark

certify the information shown herein is true and correct

*George Clark*  
Signature of Ground Party Chief

I, Kenneth E. Davis

certify that this corner record correctly represents work performed by me or under my direction in compliance with the "Corner Recordation Act"

*Kenneth E. Davis*  
KENNETH E. DAVIS  
4975 S  
Date: *Sept 20, 2000*  
Employer: *Surveying, Inc.*

## Sketch of Corner

## Section

Office of Clerk and Recorder, County of Lincoln

This "corner record" was filed for record on Sept 20, 2000

was noted on the cross-index plat and is assigned page No. 10451

in book No. Coral M. Cummings By DBB

County Official

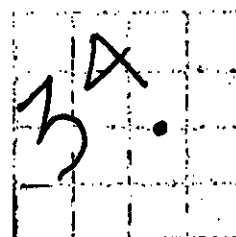

SEC. 34

Cross Index No. C-W-E 1/64 T. 31 N., R. 31 W., PMM

• THIS CORNER