

CERTIFIED CORNER RECORDATION

1/4
 Corner 30 | 29 T. 31 N. R. 31 W. P.M.M. Lincoln County

1893 G.L.O. Survey by Daniel P. Mumbrue, Book 2826 Page 52

"Set a post 3 ft. long, 3 ins. square, 24 ins. in the ground, for 1-4 Sec. Cor., marked 1-4 S. on W. face; from which
 A tamarack 12 ins. diam. bears S61 1/2°E 29 lks, distant marked 1-4 S.B.T.
 A fir 12 ins. diam. bears N59 1/2°W 18 lks, distant marked 1-4 S.B.T."

1999 Remonumentation by S. R. Smith

I find no original evidence of the post or bearing trees. I also search for original evidence of the two meander corners to the south of the 1/4 corner. I find a tree with a face blaze, but no scribing, at approximately the correct position for the northeast bearing tree on the right bank of the river. Being unable to prove that this is the G.L.O. bearing tree, I do not use this evidence in calculating the position of the 1/4 corner. The calculated corner position falls in a farm field, 1.6' West of a north-south fence. At the position determined by single proportionate measurement, I set an aluminum pipe, 2 1/2" diameter, 30" long, with 3 1/4" diameter Montana Department of Transportation aluminum cap, marked as shown below. Top of cap is flush with the ground, from which,

A 3 1/2' long galvanized steel post with M.D.T. survey decal attached, bears East 1.58' distant. Set in fenceline.

A 1 5/16" diameter brass disc, marked "SMITH 4740LS", set 2' above ground on the north side of power pole #309501, bears S60°E 27.93' distant.

A 1 5/16" diameter brass disc, marked "SMITH 4740LS", set 2' above ground on the west side of a railroad tie fence corner post, bears S09°E 16.14' distant.

A 3 1/2' long galvanized steel post with M.D.T. survey decal attached, bears West 0.62' distant. Set in field.

Bearings listed above in remonumentation section were measured with a hand compass, declination 19.50' East.

Refer to the Certificate of Survey filed in conjunction with this Corner Recordation for ties to adjacent section controlling corners.

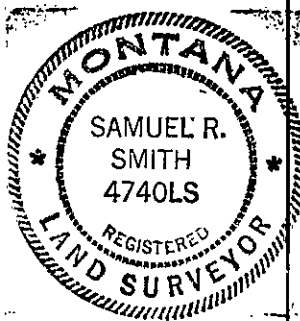
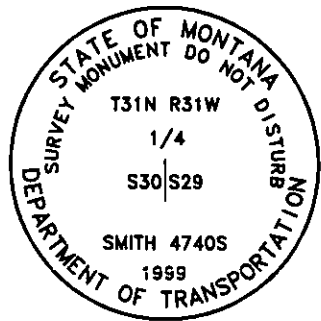
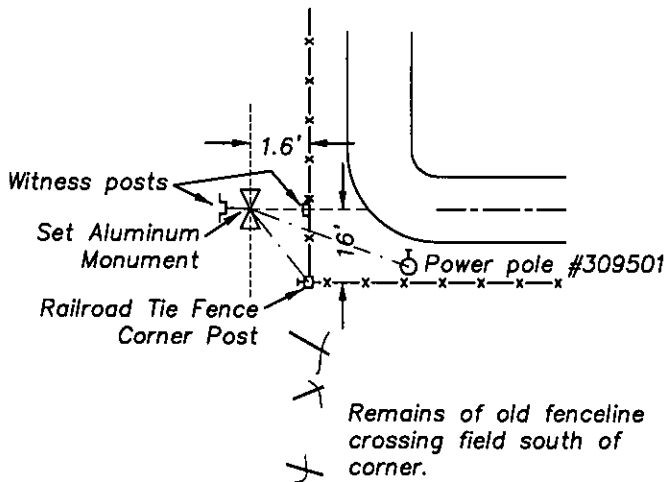

SKETCH OF CORNER

CERTIFICATION

I, S. R. Smith
 certify the information shown herein is true and correct.
S. R. Smith
 Signature Ground Party Chief

I, S. R. Smith
 certify that this Corner Record correctly represents work performed by me or under my direction in compliance with the "Corner Recordation Act" (70-22-101, et seq., M.C.A.)
S. R. Smith
 Signature of Surveyor & Seal

Date: 09/08/00 Reg. No. 4740LS
 Employer: Smith Surveying & Consulting

Office of Clerk and Recorder, County of Lincoln. This "corner record" was filed for record on 14th Sept 2000 was noted on the cross-index plat and is assigned page No. 10450, in book No. Coral M. Cummins By O&B County Official

Cross Index No. T-5 T. 31 N. R. 31 W. P.M.M.

Adopted July 1, 1981, Montana Board of Professional Engineers & Land Surveyors

Sec. 30

X corner this sheet