

CERTIFIED CORNER RECORDATION

Corner CNS 1/64 Sec. 27 T. 31N R. 30W P.M., MT Lincoln County

- I. 1976 Certified Corner Recordation by Melvin Lauteren, 4232S: Set by survey, a 1 in. diam. iron pipe, with brass cap mkd. as shown, per Certificate of Survey no. 215, by 4232S.

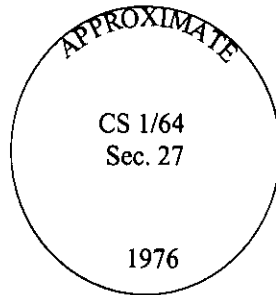

- II. Found a 1 1/4 in. diam. iron pipe, with a 3 in. diam. brass cap, mkd. as shown above, and not accepted, corner was projected per Certificat of survey no. 215, by 4232S.
- III. Set by survey, a driveable aluminum rod, 30 ins. long, 3/4 in. diam., 26 ins. in the ground, with a 3 1/4 in. diam. aluminum cap, mkd. as shown. A collar of stone, surrounds the monument.

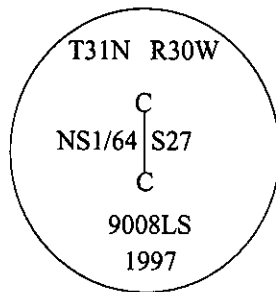

Established two bearing trees:

A larch, 12 ins. diam., bears S89°E, 20.2 ft. dist., mkd. "CNS1/64 S27 BT".

A fir, 14 ins. diam., bears S27°W, 11.9 ft. dist., mkd. "CNS1/64 S27 BT".

Painted bearing trees and attached Land Survey Monument and Bearing Tree signs.

The found iron pipe, bears N45°E, 2.5 ft. dist. from the newly established monument.

Magnetic Declination: 20° East.

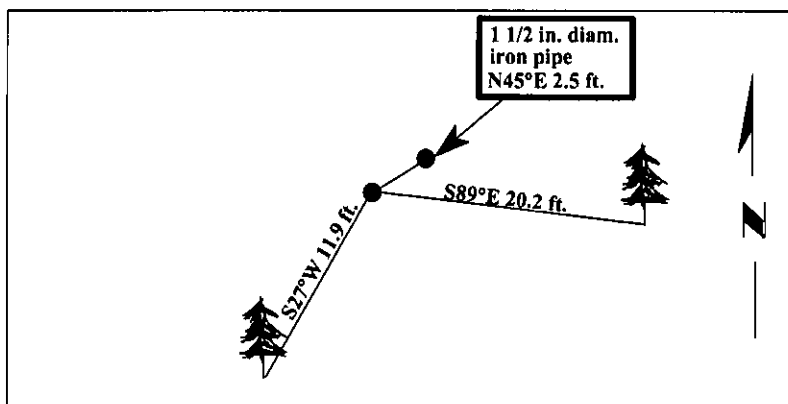

SKETCH OF CORNER

I, Jeff Hintz

certify the information shown herein is true and correct.

CERTIFICATION

I, Ronald A. Pearson

certify that this Corner Record correctly represents work performed by me or under my direction in compliance with the "Corner Recordation Act" (70-22-101, et seq., M.C.A.)

Ronald A. Pearson

Signature of Surveyor & Seal

Date: 06/25/97

Reg. No.: 9008LS

Employer: U.S. FOREST SERVICE

Office of Clerk and Recorder, County of LINCOLN. This "corner record" was filed for record on JULY 31, 1997 was noted on the cross-index plat and is assigned page No. 9809 in book No. _____

CORAL M. CUMMINGS

County Official

Sec. 27

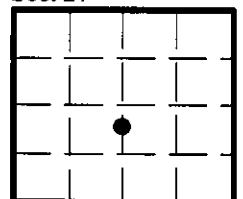

• - corner this sheet

Cross Index No. T.5-15 T. 31N R. 30W P.M., MT