

# CERTIFIED CORNER RECORDATION

Corner **MS 10935 COR. 3** Sec. **10** T. **31N** R. **30W** P.M., MT. **Lincoln** County  
**LAST CHANCE**  
**NO. 6**

I. 1972 Original B. L. M. survey by Arthur C. Rader: Cor. No. 3. Set an iron post, 1 1/2 ins. diam., 30 ins. long, 24 ins. in the ground, with brass cap mkd. 3-LC6-10935; from which:

- A pine, 6 ins. diam., bears N 70°W, 9.0 ft. dist., mkd. 3-LC6-10935 BT.
- A pine, 8 ins. diam., bears S 50°W, 16.0 ft. dist., mkd. 3-LC6 10935 BT.

II. Found a 1 1/2 in. diam. iron pipe, 8 ins. above ground, firmly set in a collar of stone, with a 3 1/4 in. diam. brass cap, mkd. as shown:

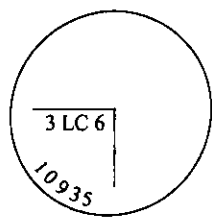

from which:

- A pine snag, 8 ins. diam., bears N 70°W, 8.4 ft. dist., mkd. 3 LC6 10935 BT.
- A down pine, 8 ins. diam., bears S 60°W, 16.0 ft. dist., mkd. 3 LC 6 10935 BT.
- A 6 ft. steel guard post bears SW, 3.2 ft. dist., with a Property Boundary decal attached.
- A 6 ft. steel guard post bears NE, 2.0 ft. dist., with a Property Boundary decal attached.

III. Establish two new bearing trees:

- A fir, 10 ins. diam., bears S 60°E, 14.4 ft. dist., mkd. X BT.
- A fir, 13 ins. diam., bears N 54°E, 20.1 ft. dist., mkd. 3 LC6 10935 BT.

Painted red bands around the bearing trees and attached Land Survey Monument and Bearing Tree signs.

Magnetic Declination: 20° East

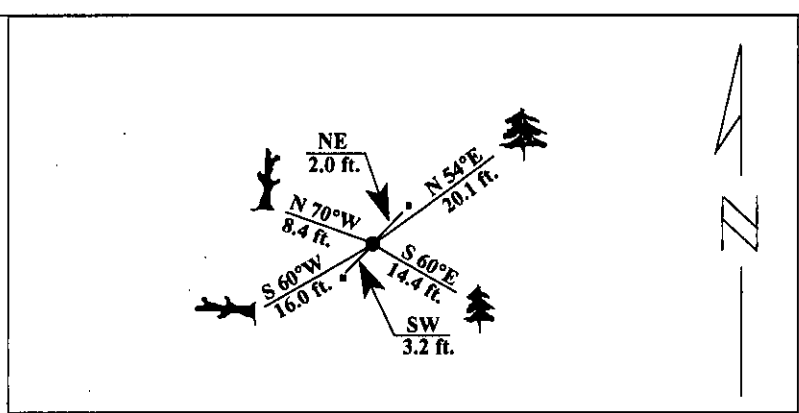
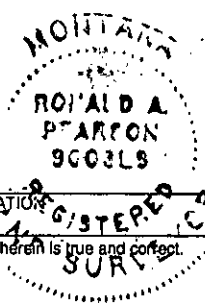

**SKETCH OF CORNER**

CERTIFICATION

I, Jeff Hintz  
certify the information shown herein is true and correct.

Signature Ground Party Chief

I, Ronald A. Pearson  
certify that this Corner Record correctly represents work performed by me or under my direction in compliance with the "Corner Recordation Act" (70-22-101, et seq., M.C.A.)

Signature of Surveyor & Seal

Date: 1/24/96

Reg. No.: 9008LS

Employer U.S. FOREST SERVICE

Office of Clerk and Recorder, County of Lincoln. This "corner record" was filed for record on 2-28-96 was noted on the cross-index plat and is assigned page No. 8246, in book No. \_\_\_\_\_

Carol M. Cummings B.S.B.  
 County Official

Sec. 10

● - corner this sheet