

CERTIFIED CORNER RECORDATION

Corner MS 10965 COR. 2 Sec. 24 T. 31N R. 30W P.M., Lincoln County
CPD NO. 6 LODE MT.

- I. 1976 Original B. L. M. survey by Arthur C. Rader: Set an iron post, 30 ins. long, 1 in. diam., 24 ins. in the ground, with brass cap mkd. 2CPD6-10965; from which:
- A fir, 12 ins. diam., bears S 73° 05' W, 29.0 ft. dist. mkd. 2CPD6-10965 BT.
A pine, 8 ins. diam., bears N 2°58' W, 24.0 ft. dist., mkd. 2CPD6-10965 BT.
- II. Found a 1 1/2 in. diam. iron pipe, 15 ins. above ground, firmly set, with a 3 in. diam. brass cap, mkd. as shown:.

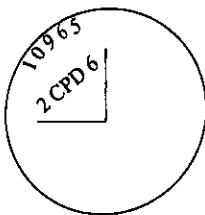

from which:

- A fir, 13 ins. diam., bears S 73°W, 29.0 ft. dist., mkd. with visible scribe marks.
A dead pine, 8 ins. diam., bears N 9°E, 24.0 ft. dist., mkd. with visible scribe marks. (Rec: N 2°58' W)
A steel guard post bears SW, 0.7 ft., dist., with a property boundary decal attached.
A steel guard post bears NW, 0.9 ft. dist., with a property boundary decal attached.

- III. Established one new bearing tree:

A larch, 9 ins. diam., bears S 23° E, 13.2 ft. dist., mkd. "X" BT.

Painted red bands around the bearing trees and attached Land Survey Monument and Bearing Tree signs.

Magnetic Declination: 20° East.

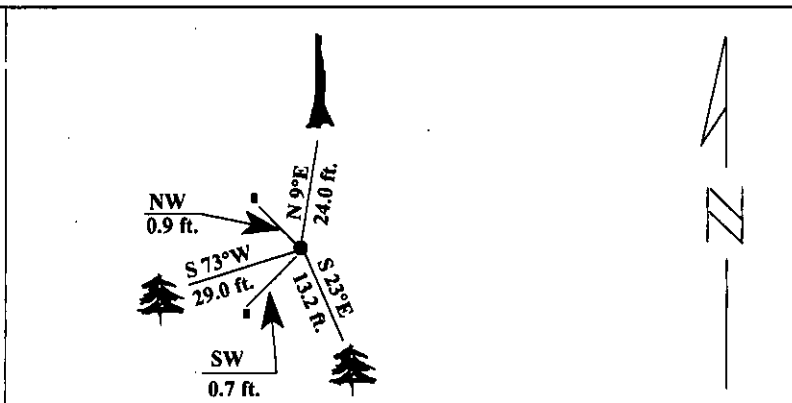

SKETCH OF CORNER

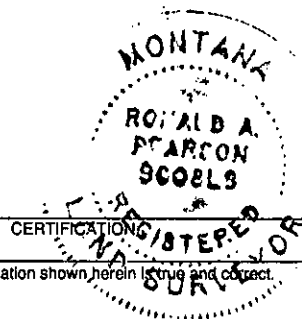

I, Jeff Hintz
certify the information shown herein is true and correct.

Signature Ground Party Chief

I, Ronald A. Pearson
certify that this Corner Record correctly represents work performed by me or under my direction in compliance with the "Corner Recordation Act" (70-22-101, et seq., M.C.A.)

Signature of Surveyor & Seal

Date: 1/11/96

Reg. No.: 9008LS

Employer U.S. FOREST SERVICE

Office of Clerk and Recorder, County of Lincoln. This "corner record" was filed for record on 2-28-96 was noted on the cross-index plat and is assigned page No. 8223, in book No. _____

Coral M. Cummings
County Official

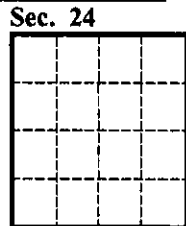

• - corner this sheet

Cross Index No Cor. 2 M.S. 10965 C.P.D. No.6 Lode T. 31N R. 30W PMM

Adopted July 1, 1981, Montana Board of Professional Engineers & Land Surveyors