

CERTIFIED LAND CORNER RECORDATION

DESCRIPTION OF CORNER EVIDENCE FOUND, AND ORIGINAL RECORD (IF KNOWN)
T31N R30W Montana Principal Meridian G.L.O. notes book 8942 page 48 has an iron post 30" long, 2 1/8" in diameter, 24" in the gourd with a brass cap marked: T31N Found brass cap in good condition and undisturbed.

R31W R30W
S19
S24 CC
B30
1962

Record: 17" pine bearing N49°E, 45 lks., marked CC T31N R30W S19 BT
Found Bearing tree alive and presently 24" in diameter

CONTINUED ON REVERSE SIDE

DESCRIPTION OF MONUMENT AND ACCESSORIES ESTABLISHED
TO PERPETUATE THE ORIGINAL LOCATION OF THIS CORNER:

Date of work June '74

No added monumentation

SKETCH, WITH COURSE AND DISTANCE TO ADJACENT CORNERS IF DETERMINED IN THIS SURVEY.
(MAY SKETCH OR PASTE REPRODUCTION ON REVERSE SIDE.)

See reverse side

Surveyor's Seal

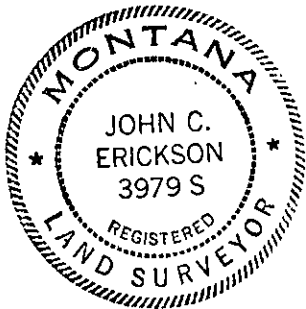

I, James R. Staples
certify that the information shown herein is true and correct.

Signature of Ground Party Chief

I, JOHN C. ERICKSON
certify that I have carefully performed or reviewed the work done on the diagrammed corner as reported on this recordation form and approve the same.

Signature of Surveyor

3979 S
Registration Number

DIAGRAM OF CORNER:
T31N
N. R31W R30W

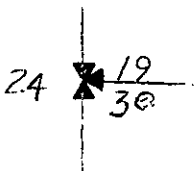

= Corner recorded on the sheet

Office of Clerk and Recorder, County of Lincoln
This "corner record" was filed for record on the 28 day of Mar 1989, was noted on the cross-index plat and is assigned page No. 4023, in book No. 1989
County Official

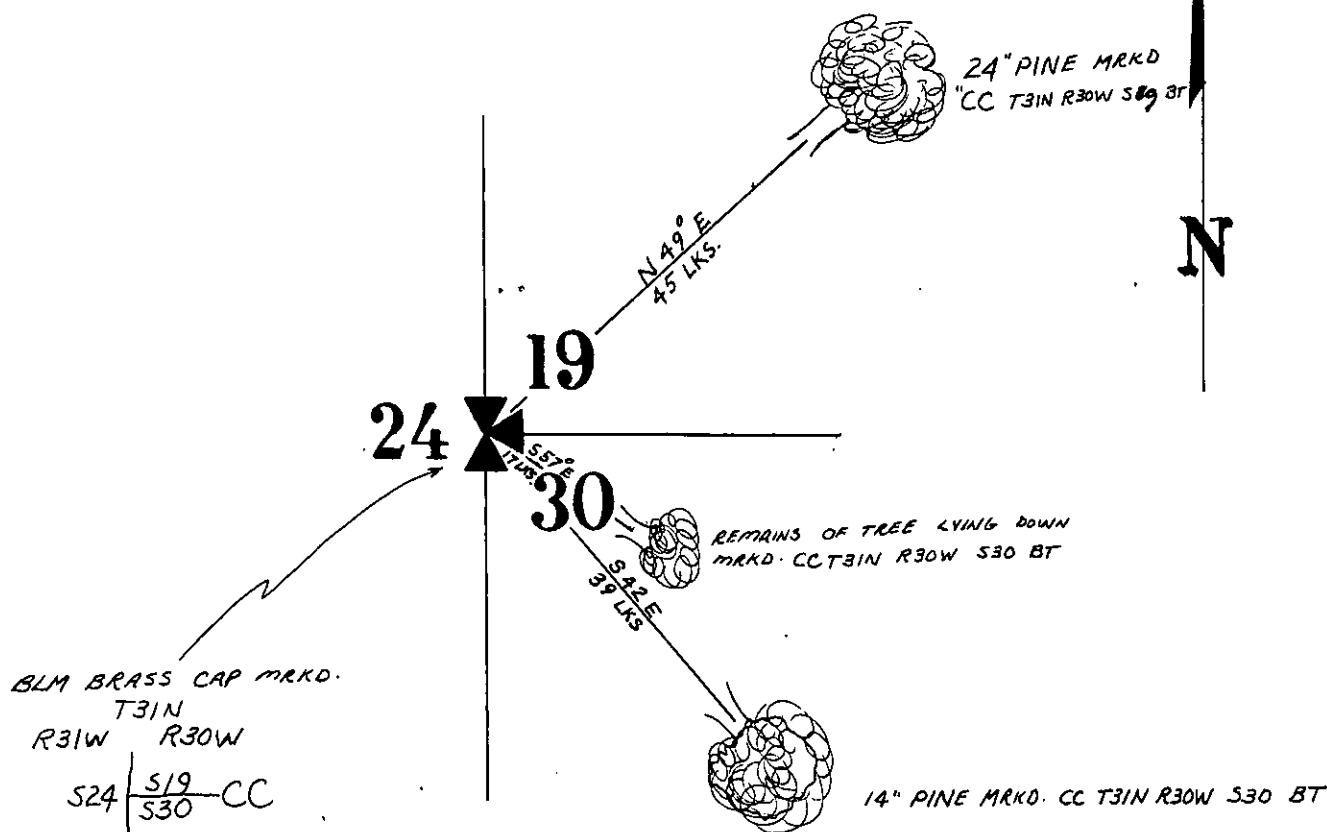

Description of evidence and original record continued from side 1

Record: Stumphole bearing S57°E, 17 lks., remains of tree marked CC T31N R30W S30 BT

Found: Remains of the tree but could not find any indication of the stumphole

Record: 13" pine S42°E, 39 lks., marked CC T31N R30W S30 BT

Found: Bearing tree alive and still growing and presently 14" in diameter