

29 | 28  
32 | 33

Cadastral Retracement of sec. cor.

T31N R30W Montana Principal Meridian

**CERTIFIED LAND CORNER RECORDATION**

DESCRIPTION OF CORNER EVIDENCE FOUND, AND ORIGINAL RECORD (IF KNOWN)

T31N R30W Montana Principal Meridian G.L.O. notes book 8942 page 44 has iron post 30" long, 2 $\frac{1}{2}$ " in diameter 27" in the ground with a brass cap marked T31N R30W

Found brass cap undisturbed and in good condition.

S29 | S28  
S32 | S33  
1964

Record: 24" larch bearing N28°E, 95 lks. marked T31N R30W  
Found: Bearing tree alive and still growing with same diameter of 24"

Record: 18" pine bearing S43 $\frac{1}{2}$ °E, 82 lks. with overgrown blaze.  
Found: ~~Bearing tree alive and still growing and presently 21" in diameter~~

DESCRIPTION OF MONUMENT AND ACCESSORIES ESTABLISHED  
TO PERPETUATE THE ORIGINAL LOCATION OF THIS CORNER:

Date of work: 4/1/74

No added monumentation.

SKETCH, WITH COURSE AND DISTANCE TO ADJACENT CORNERS IF DETERMINED IN THIS SURVEY.  
(MAY SKETCH OR PASTE REPRODUCTION ON REVERSE SIDE.)

Sketch on reverse side.

Surveyor's Seal

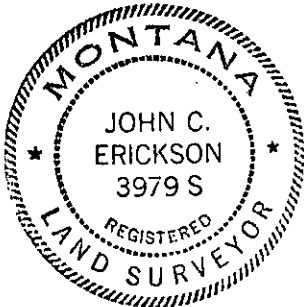

I, James R. Staples  
certify that the information shown herein is true and correct.

James R. Staples  
Signature of Ground Party Chief

JOHN C. ERICKSON

I, \_\_\_\_\_  
certify that I have carefully performed or reviewed the work done on the diagrammed corner as reported on this recordation form and approve the same.

John C. Erickson  
Signature of Surveyor

3979 S  
Registration Number

DIAGRAM OF CORNER:

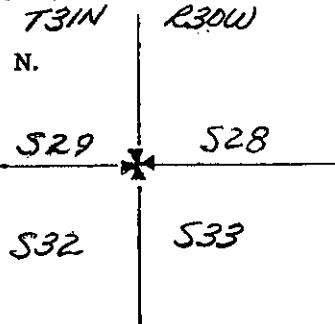

= Corner recorded on the sheet

Office of Clerk and Recorder, County of Lincoln

This "corner record" was filed for record on the 28 day of Mar 1989, was noted on the cross-index plat and is assigned page No. 4005, in book No. \_\_\_\_\_

Janet B. Siegel by Bill Buckhoff  
County Official

29

28

24" LARCH BEARING N28°E,  
95 lks., marked  
T31N R30W BT

23"  
18" LARCH BEARING  
N78°W, 26 lks.  
VISIBLE MKS: R30W S29

BLM BRASS CAP MKRD.  
T31N R30W

S29	S28
S32	S33
1964	

32

12" FIR BEARING  
S13°W, 28 lks,  
SCRIBE COVERED

33

21" PINE BEARING  
S43 1/2°E, 82 lks.,  
OVERGROWN BLAZE

-----  
Corner evidence and original description continued

Record: Decayed stump bearing S7°W, 97 lks. with no visible marks  
Found: No indication

Record: 18" larch bearing N78°W, 26 lks. marked R30W S29  
Found: Bearing tree alive and still growing and presently 23" in diameter

Record: ~~18~~ 12" fir bearing S13°W, 28 lks. marked T31N R30W S32 BT  
Found: Bearing tree alive and still growing and presently 12" in diameter with scribe now covered.