

CERTIFIED LAND CORNER RECORDATION

DESCRIPTION OF CORNER EVIDENCE FOUND, AND ORIGINAL RECORD (IF KNOWN)

T31N R30W Montana Principal Meridian G.L.O. notes book 8942 page 46 has an iron post 30" long,  $2\frac{1}{8}$ " in diameter 27" in the ground with a brass cap marked T31N R30W Found the brass cap in good condition and undisturbed.  
 $\frac{1}{4}$  S30  
S31  
1964

Record: 22" dead larch bearing S87 $\frac{1}{2}$ °W, 53 lks., marked  $\frac{1}{4}$  S31 BT  
Found: Bearing tree still standing

Record: 22" fir bearing N4°W, 27 lks., marked with overgrown blaze  
Found: 22" fir with overgrown blaze 26 lks., but bearing N2°E  
CONTINUED ON REVERSE SIDE

DESCRIPTION OF MONUMENT AND ACCESSORIES ESTABLISHED  
TO PERPETUATE THE ORIGINAL LOCATION OF THIS CORNER:

Date of work: May '70

No added monumentation

SKETCH, WITH COURSE AND DISTANCE TO ADJACENT CORNERS IF DETERMINED IN THIS SURVEY.  
(MAY SKETCH OR PASTE REPRODUCTION ON REVERSE SIDE.)

See sketch on reverse side

Surveyor's Seal

James R. Staples

I, \_\_\_\_\_  
certify that the information shown herein is true and correct.

*James R. Staples*  
Signature of Ground Party Chief

JOHN C. ERICKSON

I, \_\_\_\_\_  
certify that I have carefully performed or reviewed the work done on the diagrammed corner as reported on this recordation form and approve the same.

*John C. Erickson*  
Signature of Surveyor

DIAGRAM OF CORNER:

N. T31N R30W

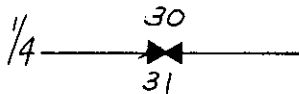

= Corner recorded on the sheet

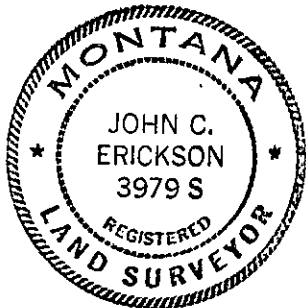

3979.5  
Registration Number

Office of Clerk and Recorder, County of Lincoln

This "corner record" was filed for record on the 28 day of Mar 1989, was noted on the cross-index plat and is assigned page No. 3991, in book No. \_\_\_\_\_

*Janet B. Supis by Eric Buckhoff*  
County Official

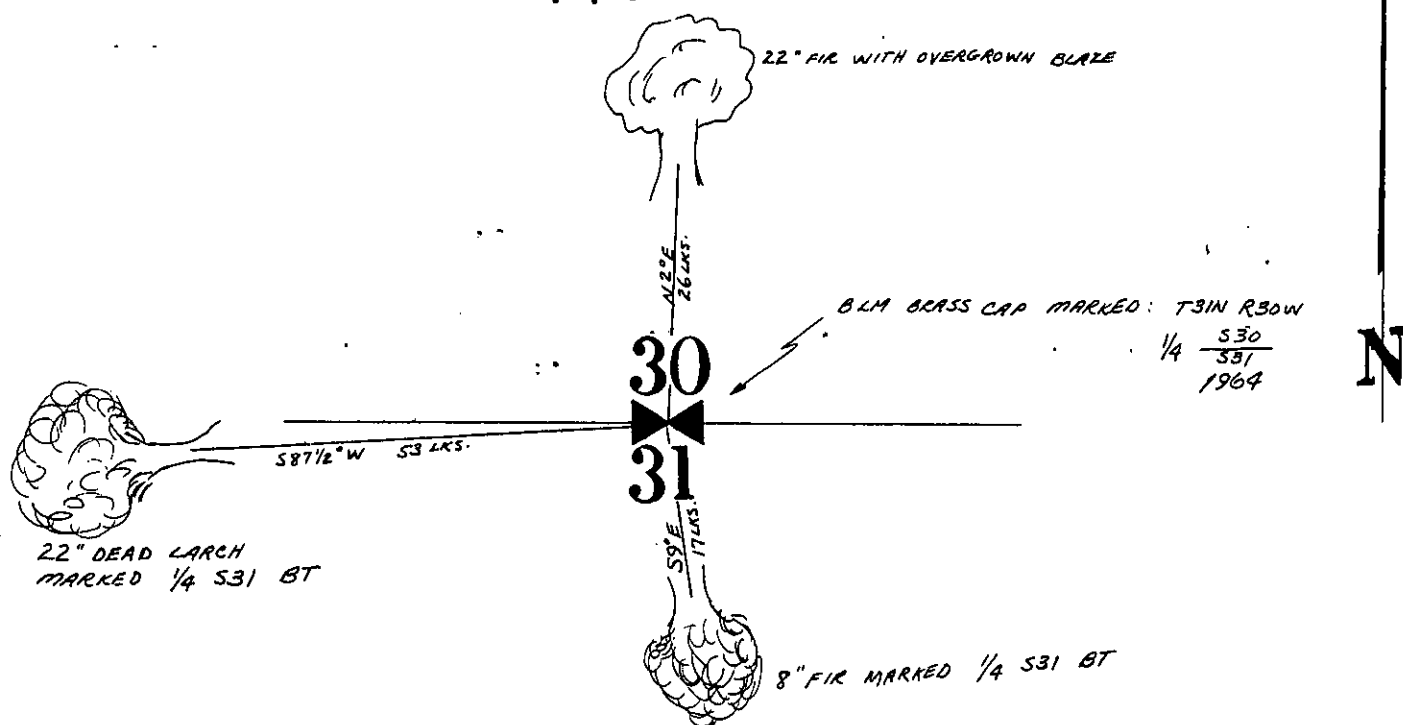

-----  
Description of evidence and original record continued from side 1

Record: 5" spruce bearing S9°E, 17 lks., marked 1/4 S31 BT  
Found: Bearing tree alive and presently 8" in diameter

# CERTIFIED LAND CORNER RECORDATION

Cadastral Retracement  $\frac{1}{4}$  cor.  $\frac{20}{29}$  T31N R30W Montana Principal Meridian

## DESCRIPTION OF CORNER EVIDENCE FOUND, AND ORIGINAL RECORD (IF KNOWN)

T31N R30W Montana Principal Meridian G.L.O. notes book 8942 page 48 has an iron post 30" long,  $2\frac{1}{8}$ " in diameter, 27" in diameter with a brass cap marked:

Found the brass cap in good condition and undisturbed.

T31N R30W  
 $\frac{1}{4}$  S 20  
S 29  
1964

Record: 28" pine bearing N25°E 94 lks., with an overgrown blaze

Found: 29" pine stump with same bearing and distance with an overgrown blaze

Record: 6" fir bearing S86°W, 12 lks., marked  $\frac{1}{4}$  S29 BT

Found: Bearing tree alive and still growing and presently 10" in diameter

## Continued on reverse side

## DESCRIPTION OF MONUMENT AND ACCESSORIES ESTABLISHED TO PERPETUATE THE ORIGINAL LOCATION OF THIS CORNER:

Date of work: 4/18/74

No added monumentation

## SKETCH, WITH COURSE AND DISTANCE TO ADJACENT CORNERS IF DETERMINED IN THIS SURVEY. (MAY SKETCH OR PASTE REPRODUCTION ON REVERSE SIDE.)

Sketch on reverse side

Surveyor's Seal

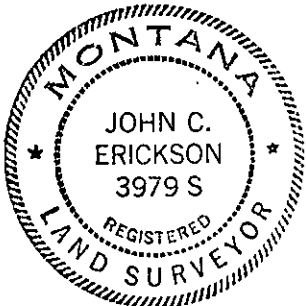

I, James R. Staples

certify that the information shown herein is true and correct.

*James R. Staples*  
Signature of Ground Party Chief

JOHN C. ERICKSON

I, certify that I have carefully performed or reviewed the work done on the diagrammed corner as reported on this recordation form and approve the same.

*John C. Erickson*  
Signature of Surveyor

## DIAGRAM OF CORNER:

N. T31N R30W  
 $\frac{1}{4}$   $\frac{20}{29}$

= Corner recorded on the sheet

3979.5  
Registration Number

Office of Clerk and Recorder, County of Lincoln

This "corner record" was filed for record on the 28 day of Mar 1989, was noted on the cross-index plat and is assigned page No. 3993, in book No.

*Paul H. Siegel by Eric Buckhoff*  
County Official

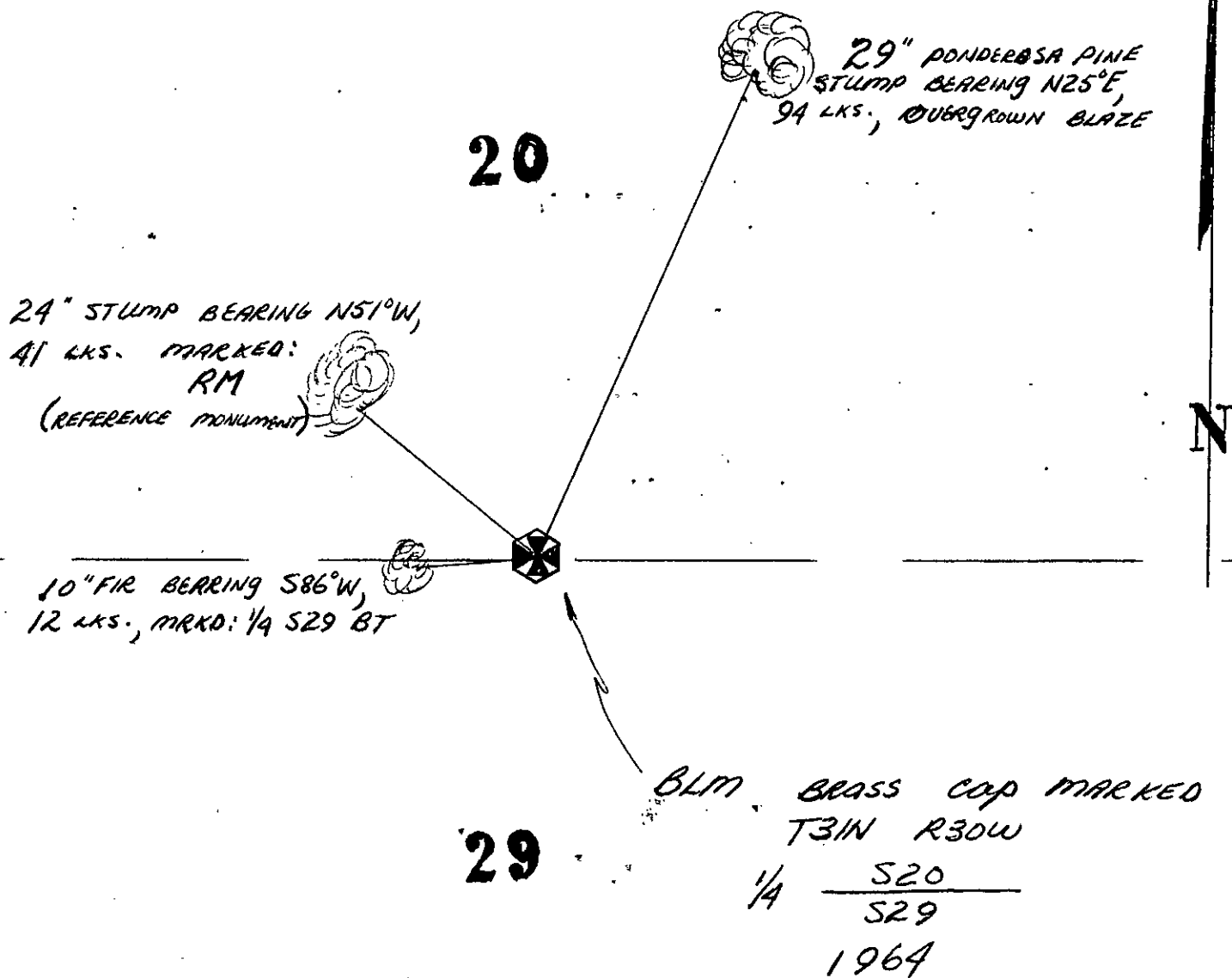

-----  
Description of evidence and original record continued

Found: 24" stump bearing N51°W, 41 lks., marked RM (Reference Monument)  
No record.