

481

CERTIFIED LAND CORNER RECORDATION

DESCRIPTION OF CORNER EVIDENCE FOUND, AND ORIGINAL RECORD (IF KNOWN)

DESCRIPTION OF CORNER EVIDENCE FOUND: S 1/4, S12, T31N, R29W, P.M.M.  
Found B.L.M. Brass Cap, 1972 From Which:

A Larch, 7 ins. dia., Bears N47 3/4°W, 67 Lks., By ART 1972  
A Doug Fir, 20 ins. dia., Bears S2°30'W, 18 lks, By ART 1972.  
ORIGINAL GLO: S 1/4 COR. S12, T31N, R29W, P.M.M.  
Set a Slate Stone 14"X7"X6", 9 ins. in Ground From Which:  
A Tamarack 6 ins. dia., Bears N43°E, 20 Lks.  
A Fir 10 ins. dia., Bears S02°30'W, 18 Lks.

{SEE REVERSE}

DESCRIPTION OF MONUMENT AND ACCESSORIES ESTABLISHED  
TO PERPETUATE THE ORIGINAL LOCATION OF THIS CORNER:

Date of work: OCT. 1980

N.A.

SKETCH, WITH COURSE AND DISTANCE TO ADJACENT CORNERS IF DETERMINED IN THIS SURVEY.  
(MAY SKETCH OR PASTE REPRODUCTION ON REVERSE SIDE.)

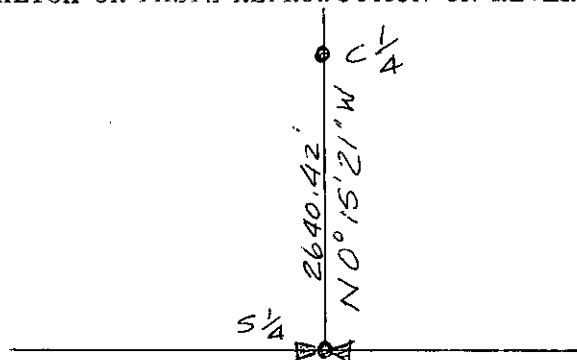

SEE CR 1-920 FOR VIEW OF ENTIRE SECTION.

Surveyor's Seal



I, Kenneth Kern

certify that the information shown herein is true and correct.

*Kenneth R Kern*

Signature of Ground Party Chief

I, Melvin D. Lauteren

certify that I have carefully performed or reviewed the work done on the diagrammed corner as reported on this recordation form and approve the same.

*Melvin D. Lauteren*

Signature of Surveyor

DIAGRAM OF CORNER:  
S12, T31N R29W  
N.

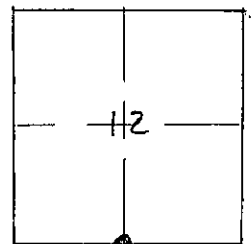

● = Corner recorded on the sheet

S 1/4, S12

4232-5  
Registration Number

Office of Clerk and Recorder, County of

*Lincoln*

This "corner record" was filed for record on the 31st day of December, 1980, was noted on the cross-index plat and is

assigned page No. 969, in book No. 1

*Edward L. Vaughn, by Betty Seel,*  
County Official, Deputy

Remonumentation Notes:

Set an Iron Post, 30 ins. long, 2 1/2 ins. dia., 24 ins. in the ground,

From Which a New Bearing Tree:

A Larch, 8 ins. dia., Bears N47 3/4°W, 67 lks, Mkd 1/4 S12 B.T.