

CERTIFIED CORNER RECORDATION

Corner 1/4 Sec. 7 & 8 T. 31N R. 29W P.M., MT Lincoln County

I. 1903 G.L.O. Original Record by George A. Fessenden et. al.: Set a slate stone, 12X10X6 ins., 8 ins. in the ground for 1/4 sec. cor. mkd. "1/4" on the W. face. Set two bearing trees.

1982 B.L.M. Remonumentation Record by Cruz D. Almanza.: The 1/4 sec. cor. of secs. 7 and 8, monumented with a slate stone, 12X10X6 ins., lying loose, mkd. "1/4" on a face, witnessed by both original bearing trees.

A larch, 4 ins. diam., bears N86°E, 28 lks. dist., mkd. with an overgrown blaze. (record)
A pine, 4 ins. diam., bears N2 1/2°W, 22 lks. dist., mkd. "1/4 S7 BT". (record-A larch tree.)

At the corner point, set an aluminum post, 30 ins. long, 2 1/2 ins. in diam., 8 ins. above the ground, with the aluminum cap mkd. as shown:

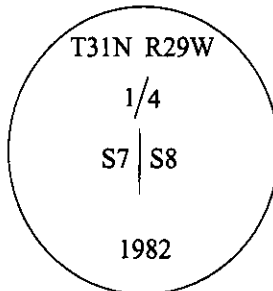

Bury the original stone alongside and raise a collar of stone, 2 ft. diam., around the aluminum post.

1985 Certified Corner Recordation by Thomas C. Hill No. 5612 S. Found a BLM monument, protruding 8 ins. above the ground, with an aluminum cap mkd. as described in the the BLM records.

from which:

A larch, 12 ins. diam., bears N85°E, 27.8 lks. dist., mkd. with a healed face. (GLO-record N86°E, 28 lks.)
A pine, 6 ins. diam., bears N02°W, 21.1 lks. dist., mkd. with visible scribe. (GLO-record-A larch tree, N2 1/2°E, 22 lks.)

II. Found a 2 1/2 in. diam. aluminum pipe, protruding 3 ins. above the ground, firmly set, with a 3 1/4 in. diam. cap mkd. as shown above.

from which:

A larch, 12 ins. diam., bears N86°E, 18.5 ft. dist., mkd. with a healed face. (GLO-record)
A fallen pine, bears N2 1/2°W, 14.5 ft. dist., mkd. with a healed face. (GLO-record A larch tree)

III. Established one new bearing tree.

A fir, 11 ins. diam., bears N32°W, 29.5 ft. dist., mkd. "1/4 S7 BT".

Painted bearing trees and attached Land Survey Monument and Bearing Tree signs.

Magnetic Declination: 20° East.

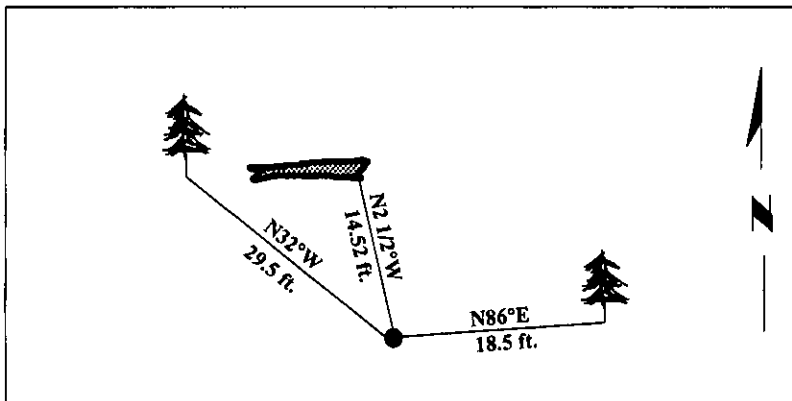
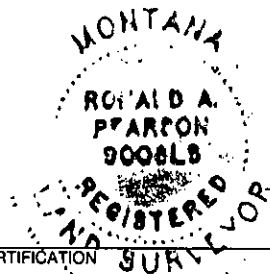

SKETCH OF CORNER

I. Rex O. Rice certify the information shown herein is true and correct.

I. Ronald A. Pearson certify that this Corner Record correctly represents work performed by me or under my direction in compliance with the "Corner Recordation Act" (70-22-101, et seq., M.C.A.)

Signature of Surveyor & Seal

Date: 12/30/96

Reg. No.: 9008LS

Employer: U.S. FOREST SERVICE

Office of Clerk and Recorder, County of LINCOLN. This "corner record" was filed for record on FEB 3, 1997 was noted on the cross-index plat and is assigned page No. 9037, in book No. CORAL M. CUMMINGS

County Official

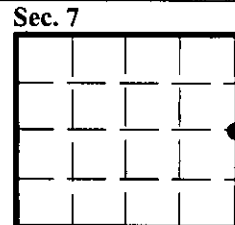

• - corner this sheet