

CERTIFIED CORNER RECORDATION

Corner W-W 1/64 Sec. 5&8 T. 31N R. 29 W P.M., MT Lincoln County

- I. 1984 Certificate of Survey No. 1362 by Thomas C. Hill No. 5612 S.: At the corner point, set an aluminum rod, 30 ins. long, 3/4 in. diam., 20 ins. in the ground, with a rock collar, with a 3 1/2 in. diam. aluminum cap mkd. as shown:

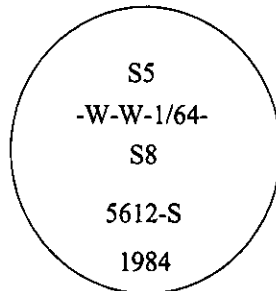

Established two bearing trees:

- A larch, 11 ins. diam., bears S12°W, 14.2 ft. dist., mkd. "S8 WW 1/64 BT".
A fir, 12 ins. diam., bears N19°W, 18.3 ft. dist., mkd. "X" "BT".

Set a guard post, South, 1.0 ft. dist. from the corner, with a "Survey Marker" decal attached.

- II. Found a driveable aluminum rod, protruding 4 ins. above the ground, firmly set, with a 3 1/4 in. diam. cap mkd. as shown above.

from which:

- A larch, 12 ins. diam., bears S42°W, 14.2 ft. dist., mkd. with visible scribe. (record-S12°W)
A down larch, 12 ins. diam., bears N11°W, 17.2 ft. dist., mkd. with no visible scribe. (record-N19°W, 18.3 ft.)

- III. Established one new bearing tree:

A fir, 12 ins. diam., bears N76°W, 10.3 ft. dist., mkd. "W-W 1/64 S5 BT".

Painted bearing trees and attached Land Survey Monument and Bearing Tree signs.

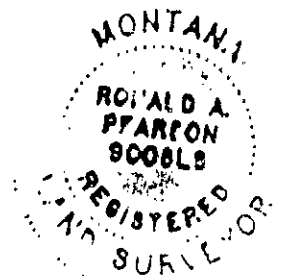

Magnetic Declination: 20° East.

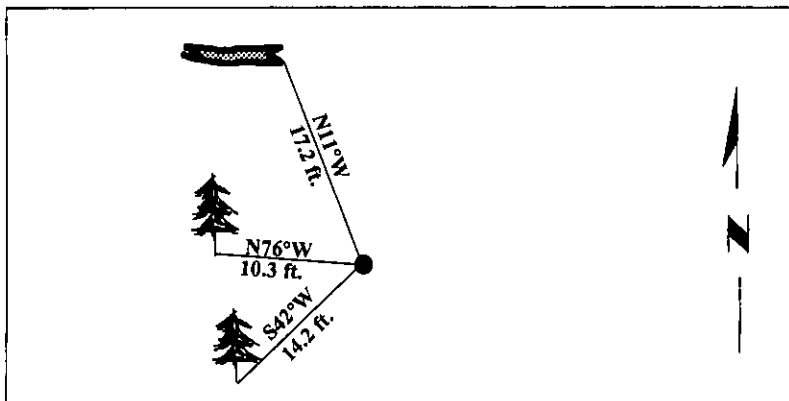

SKETCH OF CORNER

CERTIFICATION

I, Rex O. Rice
certify the information shown herein is true and correct.

I, Ronald A. Pearson
certify that this Corner Record correctly represents work performed by me or under my direction in compliance with the "Corner Recordation Act" (70-22-101, et seq., M.C.A.)

Ronald A. Pearson
Signature of Surveyor & Seal

Date: 12/30/96

Reg. No.: 9008LS

Employer: U.S. FOREST SERVICE

Office of Clerk and Recorder, County of LINCOLN. This "corner record" was filed for record on FEB 3, 1997 was noted on the cross-index plat and is assigned page No. 9036, in book No. _____

CORAL M. CUMMINGS

County Official By RFB

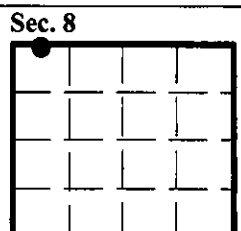

● - corner this sheet