

INSTRUCTIONS

1. Original and/or copy record used to evaluate the corner position.
2. Description of evidence found, note discrepancies in the record, state method of establishing lost or obliterated corners.
3. Description of monument and accessories set to perpetuate the corner position.
4. Sketch or corner, show all pertinent data which can best be shown in a sketch example, corner marking, topography ties, position of accessories, etc.
5. Certification must be signed and sealed by Registered Land Surveyor in State of Montana.
6. Fill in Cross Index & Section Diagram at bottom of sheet.

**CERTIFIED CORNER RECORDATION**

Corner Northwest Corner Section 1 T. 31N R. 29W P.M.M. Lincoln County

1. 80 Chains: Set a Limestone 18 X 9 X 4 inch 12 inches in the ground, for corner of Sections 12, 35 and 36 marked with 1 notch on East and 5 notches on West edges, from which, a Pine 16 inches diameter bears N76°30'E 87 links distance marked T32N., R.29W S36 BT. A Pine 20 inches diameter bears S66°20'E 78 links distance marked T31N., R.29W S1 BT. A Pine 24" diameter bears S57°20'W 47 links distance marked T31N., 29W S2BT. A Pine 24 inches diameter bears N32°50'W 69 links distance marked T32N., R.29W S35 BT.

2. Found: B.L.M. brass capped monument (marked as shown below) from which a Pine 18" diameter bears N24½°E 25.7 feet. An 8" Fir snag bears S76°30'W 27.1 feet and an 8" Pine bears N55°15'W 44.2 feet all are scribed and posted by ART 1972.

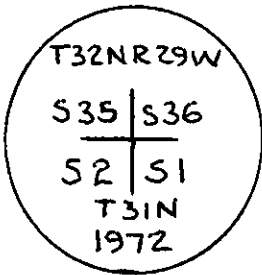

Found B.L.M. Brass capped monument marked as shown.

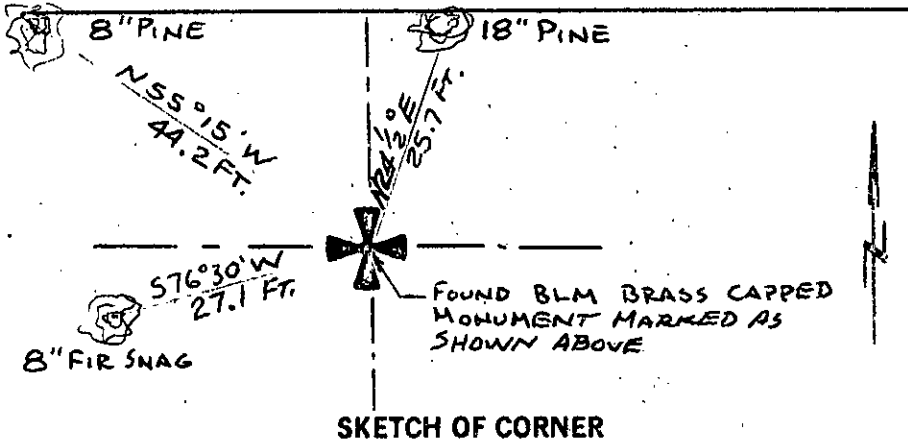

CERTIFICATION

I, \_\_\_\_\_  
certify the information shown here is true and correct.

Signature Crowned Party Chief

Jack H. Ninneman

I, \_\_\_\_\_  
certify that this Corner Record correctly represents work performed by me or under my direction in compliance with the "Corner Recordation Act" (70-22-101, et seq., M.D.A.)

Jack H. Ninneman  
Signature of Surveyor & Seal

Date: 11/18/81 Reg. No. 4661S

Employer: Ninneman Engineering Inc.

Office of Clerk and Recorder, County of Lincoln. This "corner record" was filed for record on the December 18th day of 1981, was noted on the cross-index plat and is assigned page No. 1429, in book No. 1

Eleanor L. Laughon by Betty L. Conner  
County Official & Deputy

|        |  |
|--------|--|
| Sec. 1 |  |
|        |  |
|        |  |
|        |  |