

- INSTRUCTIONS
1. Original and/or sub-record used to evaluate the corner position.
 2. Description of evidence found, note discrepancies in the record, state method of establishing lost or obliterated corners.
 3. Description of monument and accessories set to perpetuate the corner position.
 4. Sketch or corner, show all pertinent data which can best be shown in a sketch example, corner marking, topography (lies, position of accessories, etc.
 5. Certification must be signed and sealed by Registered Land Surveyor in State of Montana.
 6. Fill in Cross Index & Section Diagram at bottom of sheet.

CERTIFIED CORNER RECORDATION

Corner Reference Monument trees T. 31N R. 29W P.M.M. Lincoln County

DESCRIPTION OF CORNER EVIDENCE FOUND, AND ORIGINAL RECORD (IF KNOWN)

At the $\frac{1}{4}$ corner common to Sections 1 & 2, T31N, R29W, P.M.M. Lincoln County, Montana, we find: A rock 16" x 14" x 7" set in other rocks with one face showing, upon which is carved $\frac{1}{4}$; this rock is upon the edge of steep side slope over a wide gulch through which runs the Cripple Horse Creek Road; (Record: "On edge of a gulch 3 chains wide and 20' deep, set a slate stone 16 x 14 x 6 ins. 11" in the ground, for $\frac{1}{4}$ corner marked $\frac{1}{4}$ ") from which we find, an 8" dead tamarack snag (with plain scribing facing the corner) bearing N82°E 42 links; (Record: "From which a tamarack 7" in diameter bears N82° 40'E 42 links marks $\frac{1}{4}$ S11 BT") No trace of second BT, but Cripple Horse Road has been constructed through its location. (Record: "From which a tamarack 28" in diameter bears S79° 10' W 69 links)

DESCRIPTION OF MONUMENT AND ACCESSORIES ESTABLISHED TO PERPETUATE THE ORIGINAL LOCATION OF THIS CORNER:

Date of work: May 19, 1966

To perpetuate this corner we create two new reference monument trees, which bear from the center of the stone: A 10" Douglas-fir bears S42°E, 61 links, and a 12" ponderosa pine bears S22°W, 52 links distance; both bouble blazed and scribed RM. We piled rock around the original corner; We posted above corner rock with metal "monument sign"; put FS bearing tree posters on RM trees; we put a BLM bearing tree sign on the original 7" tamarack bearing tree; and we put up two new boundary signs on both ownership lines, one interior, and one between Sections 1 and 2.

Reproduced from recordation form Page No. 282 Book No. 1 Lincoln County Courthouse. Filed October 4, 1972 by Stanley J. Skousen 2532S

Found: Trees as shown below with unmarked location posters and trees neither blazed nor scribed.

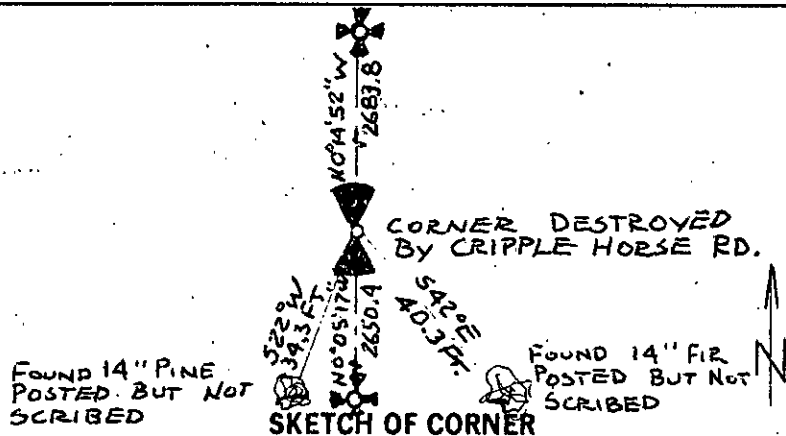

CERTIFICATION

I, Jeff Paullin
certify the information shown herein is true and correct.

Signature Ground Party Chief
Jack H. Ninneman

I, Jack H. Ninneman
certify that this Corner Record correctly represents work performed by me or under my direction in compliance with the "Corner Recordation Act" (70-22-101, et seq., M.D.A.)

Jack H. Ninneman
Signature of Surveyor & Seal
Date: 11/30/81 Reg. No. 4661S

Employer: Ninneman Engineering Inc.

Office of Clerk and Recorder, County of Lincoln. This "corner record" was filed for record on the December 7th day of 1981 was noted on the cross-index plat and is assigned page No. 1427, in book No. 1

Cross Index No. C-21 T. 31N R. 29W PMM

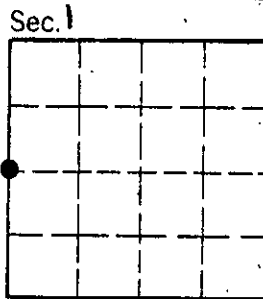

• corner this sheet