

Corner SEC COR 24^{13|18}₁₉ T. 31 N. R. 29 W. P.M.M. LINCOLN County

- I. 1898 East and North boundaries of T31N, R29W by Paul S. A. Rickel: Set a slate stone, 18x12x8 ins., 12 ins. in the ground for cor. of secs. 13, 18, 19 & 24 and 4 bearing trees.

1972 BLM Remonumentation by Joseph E. French: The cor. of secs. 13, 18, 19 & 24, on the W. boundary of the Tp., monumented with a slate stone, 16x12x8 ins., set 12 ins. in the ground, mkd. 3 notches on the S. and N. edges, from which 2 of the original bearing trees:

A fir, 28 ins. diam., bears S38°E, 45 lks. dist., mkd. T31N R28W S19 BT.

A fir, 29 ins. diam., bears N31°10'W, 35 lks. dist., mkd. T31N R29W S13 BT.

At the corner point:

Set an iron post, 30 ins. long, 2 1/2 ins. diam., 24 ins. in the ground, with brass cap mkd. (shown below). From which new bearing trees:

A larch, 8 ins. diam., bears N34°E, 56 lks. dist., mkd. T31N R28W S18 BT.

A pine, 6 ins. diam., bears S51 1/4°W, 29 lks. dist., mkd. T31N R29W S24 BT.

bury the original stone alongside and raise a flat mound of stone, 3 1/2 ft. base around the iron post.

- II. Found: A 2 1/2 in diam. iron pipe, firmly set in a collar of stone, with 3 1/4 in. diam. BLM brass cap, 2 ins. above ground, mkd. as shown below, from which:

A larch, 13 ins. diam., bears N34°E, 37.0 ft. dist., mkd. with a healed face.

A Douglas fir, 28 ins. diam., bears S38°E, 29.7 ft. dist., mkd. with a healed face.

A pine, 12 ins. diam., bears S51°W, 19.1 ft. dist., mkd. with a healed face.

A Douglas fir, 27 ins. diam., bears N31°W, 23.1 ft. dist., mkd. with a healed face.

- III. Painted the scribed faces red and 6 in. wide red bands around the bearing trees. Attached Land Survey Monument and Bearing Tree signs. Set a 6 ft. steel post 3 ft. West, with "Land Survey Monument" and Property Boundary" decals attached.

LAT 48°26'33.51319"N
LONG 115°14'10.28762"W
NAD 83

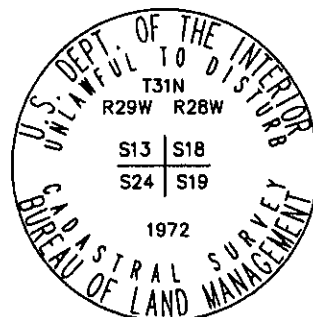

Date of Fieldwork: 5/3/2011
Survey crew: Tom Hommel
Magnetic declination: 20° East assumed
Equipment used: Hand compass and loggers tape

U.S. Forest Service, Supervisors Office, 31374 Hwy. 2, Libby, MT 59923 (406) 293-6211

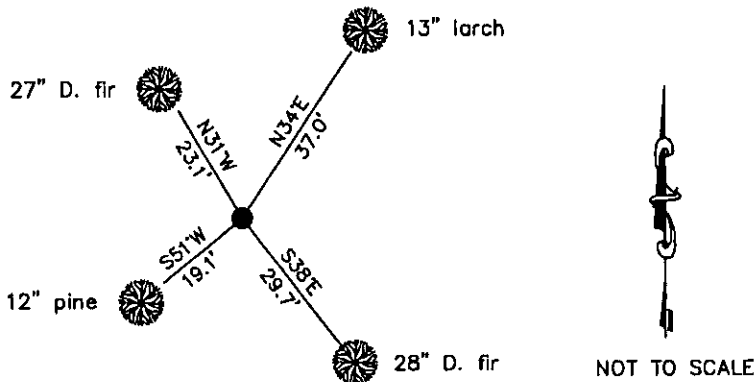

CERTIFICATION
I, Thomas M. Hommel, 10800LS
certify the information shown herein is true and correct.
Signature of Surveyor
Marc Burkhardt, 9520LS
I, Marc Burkhardt, 9520LS
certify that this Corner Record correctly represents work performed by me or under my direction in compliance with the "Corner Recordation Act" (30 USC 101, et seq., M.C.A.)
Signature of Surveyor & Seal
Date: 3/16/2012 License No. 9520LS
Employer: U. S. Forest Service

Office of Clerk and Recorder, County of Lincoln

237813 BOOK: CCR CC&R'S PAGE: 11963 Pages: 1
STATE OF MONTANA LINCOLN COUNTY
RECORDED: 03/20/2012 8:40 KOI: CC&R'S
TAMMY D. LAUER CLERK AND RECORDER
FEE: \$0.00 BY: Debbie D. Dwyer
TO: US FOREST SERVICE 31374 HWY 2, LIBBY, MONTANA 59923, Deputy

Cross Index No. N 25 T. 31N. R. 29W. P.M., MT

Adopted July 1, 1981, Montana Board of Professional Engineers & Land Surveyors

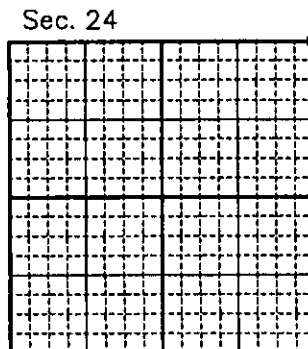

● corner this sheet