

Corner 1/4 24 | 19 T. 31 N. R. 29 W. P.M.M. LINCOLN County

I. 1898 East and North boundaries of T31N, R29W by Paul S. A. Rickel: Set a slate stone, 16x12x8 ins., 11 ins. in the ground for 1/4 sec. cor. mkd. 1/4 on W face from which:

- A pine, 24 ins. diam., bears N77°25'E, 83 lks. dist., mkd. 1/4 S19 BT.
- A pine, 12 ins. diam., bears N78°10'W, 77 lks. dist., mkd. 1/4 S24 BT.

1972 BLM Remonumentation by Joseph E. French: The 1/4 sec. cor. of secs. 19 and 24, on the E. boundary of the Tp., monumented with a slate stone, 16x12x8 ins., 11 ins. in the ground, mkd. 1/4 on the W. face, from which the remains of the original bearing trees:

- A pine stump, 30 ins. diam., bears N78°10'E, 83 lks. dist., mkd. 1/4 S19 BT. (Record: N77°25'E)
- A pine, 19 ins. diam., bears N77°25'W, 77 lks. dist., mkd. with an overgrown blaze. (Record: N78°10'W)

At the corner point:

Set an iron post, 30 ins. long, 2 1/2 ins. diam., 12 ins. in the ground, to bedrock, and in a supporting mound of stone, 6 ft. base to top, with brass cap mkd. (shown below).
From which a new bearing tree:

- A pine, 10 ins. diam., bears N54E, 20 lks. dist., mkd. 1/4 S19 BT.

bury the original stone alongside the iron post

II. Found: A 2 1/2 in diam.. iron pipe, 26 ins. above ground, firmly set in a mound of stone to 3 ins. below a 3 1/4 in. diam.. BLM brass cap mkd. as shown below, from which:

- A decayed Ponderosa pine high stump, bears N54E, 13.2 ft. dist., with 1/4 visible.
- A decayed Ponderosa pine snag, bears N77°W, 50.8 ft. dist., with 1/4 visible.

Established 2 new bearing trees:

- A Douglas fir, 11 ins. diam, bears EAST, 62.1 ft. dist., mkd. 1/4 S19 BT.
- A Ponderosa pine, 14 ins. diam., bears N12°W, 36.2 ft. dist., mkd. 1/4 S24 BT.

III. Painted the scribed faces red and 6 in. wide red bands around the bearing trees. Attached Land Survey Monument and Bearing Tree signs. Set a 6 ft. steel post 3 ft. South, with "Land Survey Monument" and Property Boundary" decals attached.

Date of Fieldwork: 5/3/2011
Survey crew: Tom Hommel
Magnetic declination: 20° East assumed
Equipment used: Hand compass and loggers tape

LAT 48°26'07.39399"N
LONG 115°14'10.36128"W
NAD 83

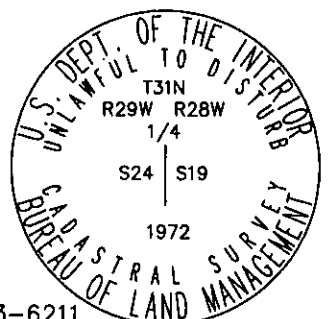

U.S. Forest Service, Supervisors Office, 31374 Hwy. 2, Libby, MT 59923 (406) 293-6211

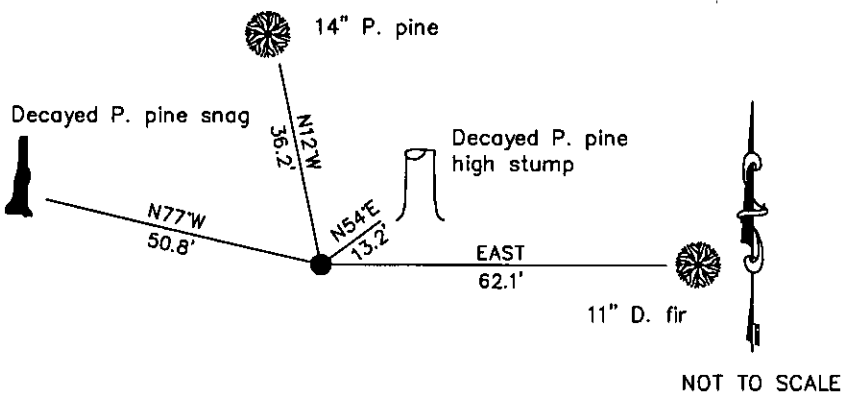

NOT TO SCALE

CERTIFICATION
I, Thomas M. Hommel, 10800LS
certify that the information herein is true and correct.
Thomas M. Hommel
Signature of Ground Point Chief
I, Mary Burkhardt, 9520LS
certify that this Corner Record correctly represents work performed by me or under my direction in accordance with the "Corner Recordation Act" (70-22-10), et seq., M.C.A.)
Mary Burkhardt
Signature of Surveyor
Date: 3/16/2011
Employer: U. S. Forest Service

Office of Clerk and Recorder, County of Lincoln

Sec. 24

237809 BOOK: CCR CC&R'S PAGE: 11959 Pages: 1
STATE OF MONTANA LINCOLN COUNTY
RECORDED: 03/20/2012 8:36 KOI: CC&R'S
TAMMY D. LAUER CLERK AND RECORDER
FEE: \$0.00 BY: *Thomas M. Hommel*
TO: US FOREST SERVICE 31374 HWY 2, LIBBY, MONTANA 59923,

Cross Index No. P 25 T. 31N. R. 29W. P.M., MT

Adopted July 1, 1981, Montana Board of Professional Engineers & Land Surveyors

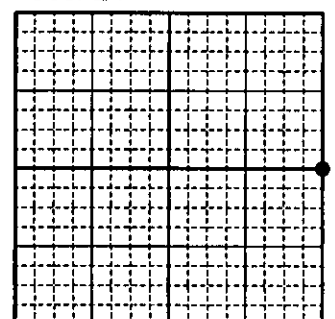

● corner this sheet