

Corner 1/4 <sup>11</sup>/<sub>14</sub> T. 31 N. R. 29 W. P.M.M. LINCOLN County

I. 1903 Subdivision lines of fractional T31N, R29W by George A. Fessenden & Ranney Y. Lyman: Set a limestone, 14x6x6 ins., 9 ins. in the ground. for 1/4 sec. cor. marked 1/4 on N. face, from which:

- A fir, 10 ins. diam., bears N20°W, 40 lks. dist., mkd. 1/4 S11 BT.
- A fir, 9 ins. diam., bears S14°E, 72 lks. dist., mkd. 1/4 S14 BT.

1972 BLM Remonumentation by Joseph E. French: The 1/4 sec. cor. of secs. 11 and 14, monumented with a limestone, 14x6x6 ins. set 9 ins. in the ground, dimly mkd. 1/4 on N. face, from which the remains of the original bearing trees:

- A fir, 16 ins. diam., bears S14°E, 70 lks. dist., mkd. with overgrown blaze. (Record: 72 lks.)
- A fir stump, 17 ins. diam., bears N20°W, 40 lks. dist., with no visible mks.

At the corner point:

Set a iron post, 30 ins. long, 2 1/2 ins. diam., 24 ins. in the ground, with brass cap mkd. (shown below) From which a new bearing tree:

- A larch, 11 ins. diam., bears N48 3/4°E, 62 lks. dist., mkd. 1/4 S11 BT.

and a bearing object:

- A granite boulder in place, 4x2x2 ft. above ground, bears N25 1/4°E, 5 lks. dist., mkd. XBO with 2 in. letters, 1 ft. below top of boulder and on SW end.

bury the original stone alongside and raise a flat mound of stone, 3 ft. diam., around the iron post.

II. Found: An iron post, 2 1/2 ins. diam., in a collar of stone, with 3 1/4 in. diam. BLM brass cap, 3 ins. above ground, mkd. as shown below, from which:

- A granite boulder, 4x2x2 ft. above ground, bears N25°E, 3.1 ft. dist., mkd. XBO with 2 in. letters, 1 ft. below top of boulder and on SW end.
- A larch, 14 ins. diam., bears N48°E, 40.9 ft. dist., mkd. with a healed face.
- A Douglas fir, 18 ins. diam., bears S14°E, 46.2 ft. dist., mkd. with a healed face.

III. Painted the scribed faces red and 6 in. wide red bands around the bearing trees and painted the XBO on the granite boulder red. Attached Land Survey Monument and Bearing Tree signs to bearing trees. Set a 6 ft. steel post 3 ft. West, with "Land Survey Monument" and Property Boundary" decals attached.

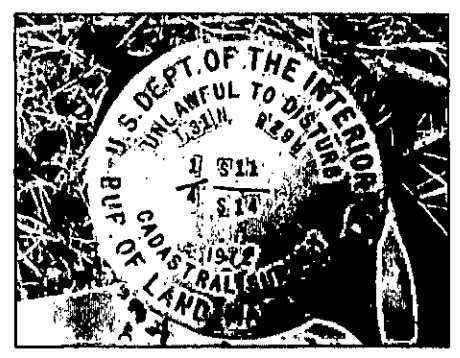

Date of Fieldwork: 5/4/2011  
 Survey crew: Tom Hommel  
 Magnetic declination: 20° East assumed  
 Equipment used: Hand compass and loggers tape

U.S. Forest Service, Supervisors Office, 31374 Hwy. 2, Libby, MT 59923 (406) 293-6211

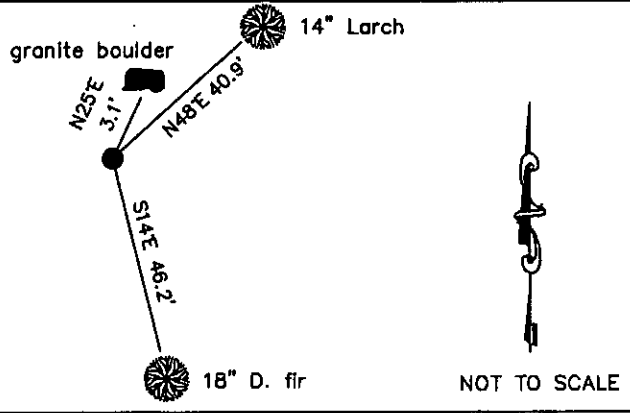

CERTIFICATION

I, Thomas M. Hommel, 10800LS  
 certify the information shown herein is true and correct.

Signature of Party Being Certified: [Signature]

I, Marc Burkhart, 9520LS  
 certify that this Corner Record correctly represents work performed by me or under my direction in compliance with the "Corner Recordation Act" (70-22-101, et seq., M.C.A.)

Signature of Surveyor & Seal: [Signature]

Date: 3/10/2012 Reg. No. 9520LS

Employer: U.S. Forest Service

Office of Clerk and Recorder, County of Lincoln

237806 BOOK: CCR CC&R'S PAGE: 11956 Pages: 1  
 STATE OF MONTANA LINCOLN COUNTY  
 RECORDED: 03/20/2012 8:33 KOI: CC&R'S  
 TAMMY D. LAUER CLERK AND RECORDER  
 FEE: \$0.00 BY: [Signature]  
 TO: US FOREST SERVICE 31374 HWY 2, LIBBY, MONTANA 59923,

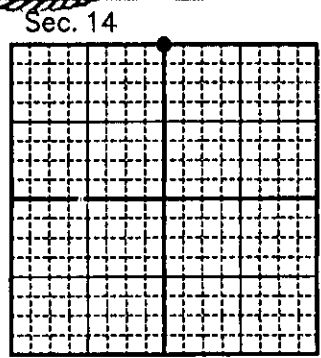

Cross Index No. J 19 T. 31N. R. 29W. P.M., MT

Adopted July 1, 1981, Montana Board of Professional Engineers & Land Surveyors

● corner this sheet