

## INSTRUCTIONS

1. Original and/or subsequent record used to evaluate the corner position.
2. Description of evidence found, note discrepancies in the record, state method of establishing lost or obliterated corners.
3. Description of monument and accessories set to perpetuate the corner position.
4. Sketch of corner, show all pertinent data which can best be shown in a sketch example, corner marking, topography ties, position of accessories, etc.
5. Certification must be signed and sealed by Land Surveyor registered in the State of Montana.
6. Fill in Cross Index & Section Diagram at bottom of sheet.

## CERTIFIED CORNER RECORDATION

Corner S1/4 SEC. 33 T. 31N R. 29W P.M.M. Lincoln County

ORIGINAL: Surveyor: Paul Bickel year: 1898

Set: A slate stone, 14 x 12 x 7 ins. 9 ins. in the ground, for 1-4 Sec. Cor. marked 1-4 on North face from which:

A 9" diam. pine bears N72-50E, 8 lks. dist. marked 1-4 S. 33 BT

A 8" diam. pine bears S37-50E, 42 lks. dist. marked 1-4 S. 4 BT

JACK W. NINNEMAN: (info from corner record)

\*\*\*\*\* 1/4 corner between Secs. 4 and 33 destroyed, Set by SE Cor. Sec. 33 and 2 BTs\*\*\*\*\*

Set: A standard brass cap monument from which

A 24" diam. Pine bears, S72E, 58.6' dist. Marked 1/4 S4 BT

A 12" diam Pine bears, N68W, 68.3' dist. Marked 1/4 BT

FOUND:

Found a 2 1/2" Brass Cap on 1 3/4" Alum. Pipe, protruding 0.80' above ground. With 4' high plastic post abutting.

A 28" diam tamarack bears S28E, 60.2' dist. With healed scribe and snow blaze and bearing tree tag.

A 18" diam pine bears N22W, 68.7' dist. With healed scribe and snow blaze and bearing tree tag.

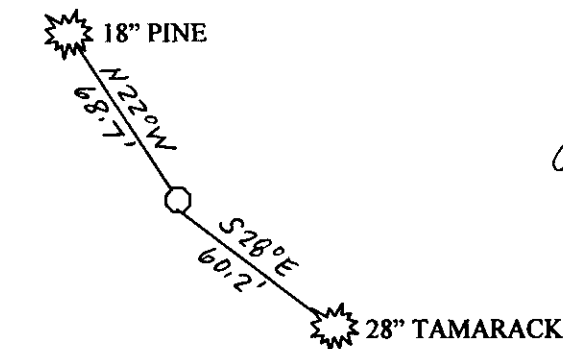
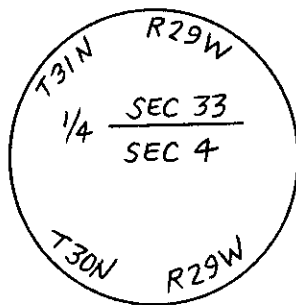

SKETCH OF CORNER

## CERTIFICATION

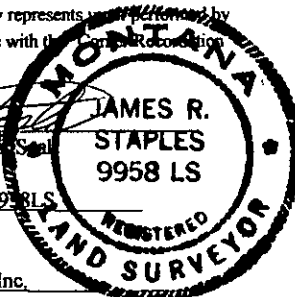
I, James R. Staples,  
Certify the information shown herein is true and correct.  
Signature Ground Party ChiefI, James R. Staples  
certify that this Corner Record correctly represents work performed by  
me or under my direction in compliance with the "Corner Recordation  
Act" (70-22-101, et seq., M.C.A.)  
Signature of SurveyorDate: 10/16/07 Reg. No. 9958 LSEmployer: J.R.S. Surveying, Inc.

Office of Clerk and Recorder, County of

record" was filed for record on \_\_\_\_\_  
was noted on the cross-index plat and  
book no. \_\_\_\_\_This "corner  
206784 BOOK: CCR CC&R'S PAGE: 11154 Pages: 1  
STATE OF MONTANA LINCOLN COUNTY  
RECORDED: 10/16/2007 9:35 KOI: CC&R'S  
TAMMY D. LAUER CLERK AND RECORDER  
FEE: \$0.00 BY:   
TO: J.R.S. SURVEYING P.O. BOX 1050, LIBBY, MONTANA 59923

County Official

Cross Index No. Z11 T. 31N R. 29W PMM