

## INSTRUCTIONS

1. Original and/or subsequent record used to evaluate the corner position.
2. Description of evidence found, note discrepancies in the record, state method of establishing lost or obliterated corners.
3. Description of monument and accessories set to perpetuate the corner position.
4. Sketch of corner, show all pertinent data which can best be shown in a sketch example, corner marking, topography ties, position of accessories, etc.
5. Certification must be signed and sealed by Land Surveyor registered in the State of Montana.
6. Fill in Cross Index & Section Diagram at bottom of sheet.

## CERTIFIED CORNER RECORDATION

Corner W1/4 SEC. 33 T. 31N R. 29W P.M.M. Lincoln County

## ORIGINAL:

Surveyor: Paul Bickel year: 1898

Set: a Slate stone, 18 x 8 x 6 ins. 12 ins in the ground. Marked  $\frac{1}{4}$  on West face. From which bears:

A 18" diam fir bears East, 14 links distance marked 1-4 S. 33 B.T.

A 10" diam fir bears N 11-33 W, 119 links distance marked 1-4 S. 32 B.T.

## FOUND:

Found a 20" Doug Fir BT with visible scribing. Used record bearing and distance to re-establish West  $\frac{1}{4}$  corner of Section 33.

## ESTABLISH:

Set: A 3  $\frac{1}{4}$ " AC on 5/8" x 12" rebar set in rock outcrop, flush with ground.

(corner to mon) S51-14-49W, a dist of 23.44'

A 3  $\frac{1}{4}$ " AC on 5/8" x 12" rebar set flush with ground.

(corner to mon) N71-11-47W, a dist of 23.99'

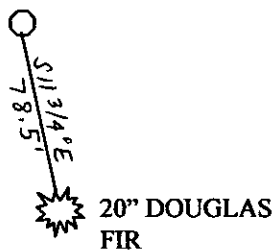
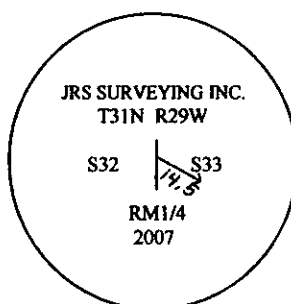
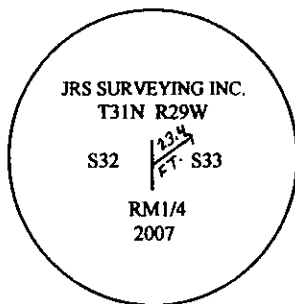

SKETCH OF CORNER

## CERTIFICATION

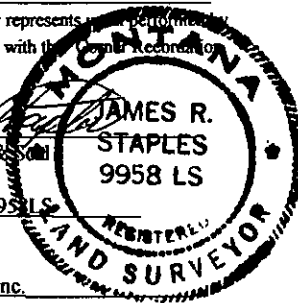
I, James R. Staples  
Certify the information shown herein is true and correct.  
Signature Ground Party ChiefI, James R. Staples  
certify that this Corner Record correctly represents what I performed  
me or under my direction in compliance with the "Corner Recordation  
Act" (70-22-101, et seq., M.C.A.)  
Signature of Surveyor & SealerDate: 10/16/07 Reg. No. 9958 LSEmployer: J.R.S. Surveying, Inc.

Office of Clerk and Recorder, County of \_\_\_\_\_

This "corner

record" was filed for record on 206783 BOOK: CCR CC&R'S PAGE: 11153 Pages: 1

STATE OF MONTANA LINCOLN COUNTY

was noted on the cross-index plat: RECORDED: 10/16/2007 9:34 KOI: CC&amp;R'S

TAMMY D. LAUER CLERK AND RECORDER

book no. \_\_\_\_\_ FEE: \$0.00

BY:

TO: J.R.S. SURVEYING P.O. BOX 1050, LIBBY, MONTANA 59923

County Official

Cross Index No. X9 T. 31N R. 29W PMM

Adopted July 1, 1981, Montana Board of Professional Engineers &amp; Land Surveyors

• - Corner this sheet

