

INSTRUCTIONS

1. Original and/or subsequent record used to evaluate the corner position.
2. Description of evidence found, note discrepancies in the record, state method of establishing lost or obliterated corners.
3. Description of monument and accessories set to perpetuate the corner position.
4. Sketch of corner, show all pertinent data which can best be shown in a sketch example, corner marking, topography ties, position of accessories, etc.
5. Certification must be signed and sealed by Land Surveyor registered in the State of Montana.
6. Fill in Cross Index & Section Diagram at bottom of sheet.

CERTIFIED CORNER RECORDATION

Corner SE-NE1/64 SEC. 33 T. 31N R. 29W P.M.M. Lincoln County

The new corner monument was established as a result of a subdivisional survey of the Section. Said subdivisional survey was made in accordance with methods and procedures contained in the Manual of Surveying Instructions (1973); U.S. Bureau of Land Management.

FOUND:

No evidence found.

ESTABLISH:

Set: 3 1/4" Alum Cap on 5/8" Rebar, protruding 0.80' above ground with 2' diam., 0.75' high rock mound, with post set 2.5' East and 4.3' South of corner with bearing tree:

A 9" diam Fir, bears N69 1/2°W, 21.31' dist, scribed: SE-NE 1/64 S33 BT, with tag

A 10" diam pine, bears S22 1/4°E, 27.63' dist, scribed: SE-NE 1/64 S33 BT with tag

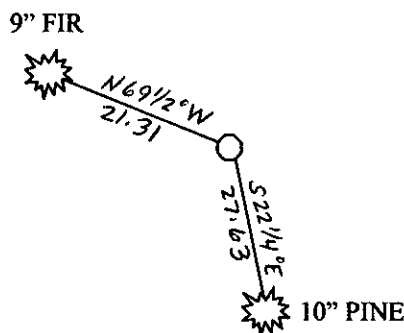
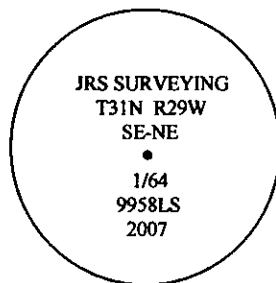

SKETCH OF CORNER

CERTIFICATION

I, James R. Staples
Certify the information shown herein is true and correct.

James R. Staples
Signature Ground Party Chief

I, James R. Staples
certify that this Corner Record correctly represents work performed by me or under my direction in compliance with the "Corner Recordation Act" (70-22-101, et seq., M.C.A.)

James R. Staples
Signature of Surveyor & Seal

Date: 10/16/07 Reg. No. 9958LS

Employer: J.R.S. Surveying, Inc.

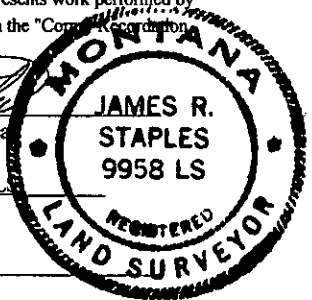

Office of Clerk and Recorder, County of

This "corner

record" was filed for record on

206778 BOOK: CCR CC&R'S PAGE: 11148 Pages: 1

was noted on the cross-index plat and is:

STATE OF MONTANA LINCOLN COUNTY

book no.

RECORDED: 10/16/2007 9:29 KOI: CC&R'S

TAMMY D. LAUER CLERK AND RECORDER

FEE: \$0.00

BY:

TO: J.R.S. SURVEYING P.O. BOX 1050, LIBBY, MONTANA 59923

County Official

Cross Index No. GG29 T. 31N R. 29W PMM

Adopted July 1, 1981, Montana Board of Professional Engineers & Land Surveyors

• - Corner this sheet