

CERTIFIED CORNER RECORDATION

CORNER E 1/16 S 14 T. 31 N., R. 29 W., P.M.M. LINCOLN COUNTY

RECORD:
NONE

FOUND EVIDENCE:
NONE

PERPETUATION:

Set a 3 1/4 inch aluminum cap stamped (see diagram below) on a 5/8 inch dia. rebar 30 inches long.
From which

A 9.5 inch DBH Douglas Fir scribed T 31 N R 29 W E 1/16 S 14 BT. bears N 81° W 3.8 feet.

A 5 inch DBH Douglas Fir scribed X BT. bears S 8° E 2.5 feet.

Painted 6 inch wide bands and attached bearing tree signs to trees.

MAGNETIC DECLINATION: 18° E

9.5" Douglas Fir

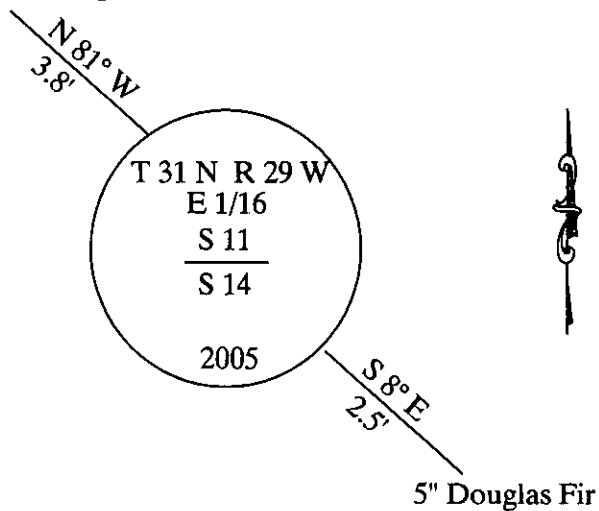

CERTIFICATION

I, GEORGE CLARK

Certify the information shown herein is true and correct

Signature of Ground Party Chief

I, KENNETH E. DAVIS

certify that this record correctly represents work performed by me or under my direction in compliance with the

"Corner Recordation Act"

(Montana Code Annotated, Title 82, Chapter 101, Section 101-101)

Signature of Surveyor Kenneth E. Davis

Date 07/13/2005

Employer Sungay Inc

4975-S

SKETCH OF CORNER

SECTION

Office of Clerk and Recorder, County of _____

This "corner record" was filed for record on 185945 BOOK: CCR CC&R'S PAGE: 10815 Pages: 1

was noted on t STATE OF MONTANA LINCOLN COUNTY

No. _____ RECORDED: 07/13/2005 9:15 KOI: CC&R'S

In book No. _____ CORAL M. CUMMINGS CLERK AND RECORDER

FEE: \$0.00

BY: George Clark

TO: FILED

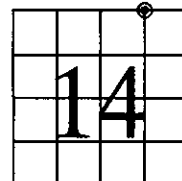

Cross Index No. E 1/16 S 14 T. 31 N., R. 29 W., P.M.M.

THIS CORNER