

CERTIFIED CORNER RECORDATION

CORNER C-E-NE 1/64 S 14 T. 31 N., R. 29 W., P.M.M. LINCOLN COUNTY

RECORD:
NONE

FOUND EVIDENCE:
NONE

PERPETUATION:

Set a 3 1/4 inch aluminum cap stamped (see diagram below) on a 5/8 inch dia. rebar 30 inches long.
From which

A 12 inch DBH Douglas Fir scribed T 31 N R 29 W C-E-NE 1/64 S 14 BT. bears S 68° W 20 feet.

A 16 inch DBH Douglas Fir scribed C-E-NE 1/64 S 14 BT. bears S 13° E 37.4 feet.

Painted 6 inch wide bands and attached bearing tree signs to trees.

MAGNETIC DECLINATION: 18° E

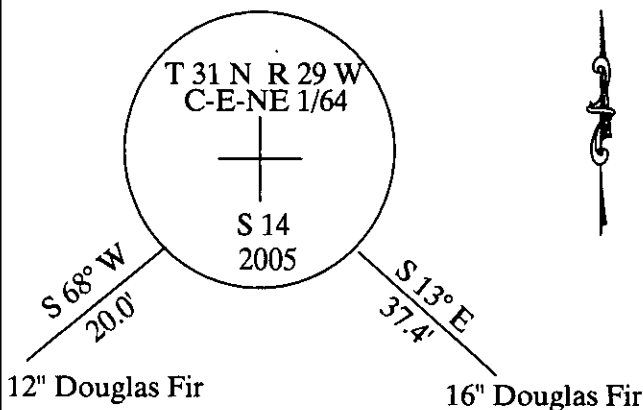

CERTIFICATION

I, GEORGE CLARK

Certify the information shown herein is true and correct
Signature of Ground Party Chief

I, KENNETH E. DAVIS

certify that the Corner Record correctly represents work
performed under my direction in compliance with the

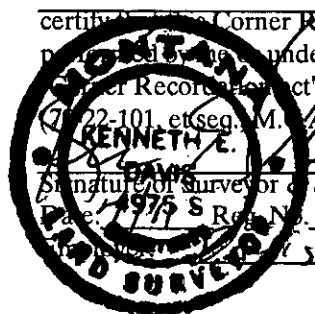

(22-101, et seq. M.C.A.)
KENNETH E. DAVIS

Signature of Surveyor & Seal

1975 S R 4975-S

SKETCH OF CORNER

Office of Clerk and Recorder, County of _____

This "corner record" was filed for record on
185942 BOOK: CCR CC&R'S PAGE: 10812 Pages: 1

No. _____ STATE OF MONTANA LINCOLN COUNTY

In book No. _____ RECORDED: 07/13/2005 9:12 KOI: CC&R'S

CORAL M. CUMMINGS CLERK AND RECORDER

FEE: \$0.00

TO: FILED

BY: Coral M. Cummings

SECTION

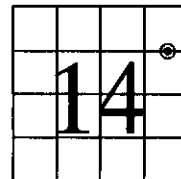

Cross Index No. C-E-NE 1/64 S 14 T. 31 N., R. 29 W., P.M.M.

THIS CORNER