

CERTIFIED CORNER RECORDATION

CORNER C-E-E 1/64 S 14 T. 31 N., R. 29 W., P.M.M. LINCOLN COUNTY

RECORD:
NONE

FOUND EVIDENCE:
NONE

PERPETUATION:

Set a 3 1/4 inch aluminum cap stamped (see diagram below) on a 5/8 inch dia. rebar 30 inches long.
From which

A 6.5 inch DBH Spruce scribed X BT. S 14 bears S 51° W 21.7 feet.

A 20 inch DBH Double Top Spruce scribed T 31N R 29 W C-E-E 1/64 S 14 bears N 53° E 14.2 feet.

Painted 6 inch wide bands with attached bearing tree signs to all trees.

MAGNETIC DECLINATION: 18° E

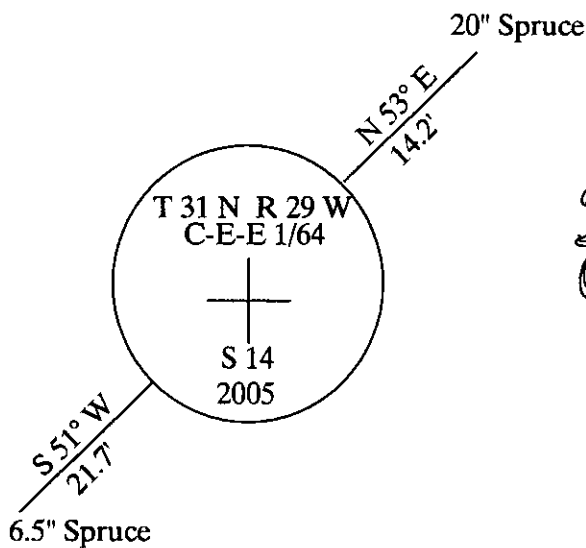

CERTIFICATION

I, GEORGE CLARK

Certify the information shown herein is true and correct

Signature of Ground Party Chief

I, KENNETH E. DAVIS

certify that this Corner Record correctly represents work
performed by me or under my direction in compliance with the

Montana Recordation Act

70-2-101 et seq. M.C.A.

Signature of Surveyor & Seal

4975-S

Enclosed

SKETCH OF CORNER

Office of Clerk and Recorder, County of _____

This "corner record" was filed for record on _____

was noted on 185938 BOOK: CCR CC&R'S PAGE: 10808 Pages: 1

No. _____ STATE OF MONTANA LINCOLN COUNTY

In book No. _____ RECORDED: 07/13/2005 9:08 KOI: CC&R'S

CORAL M. CUMMINGS CLERK AND RECORDER

FEE: \$0.00

BY: Joannee Davis

TO: FILED

Cross Index No. C-E-E 1/64 S 14 T. 31 N., R. 29 W., P.M.M.

SECTION

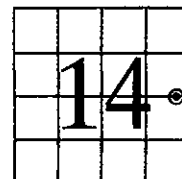

THIS CORNER