

Corner SEC COR 24 | 19 <sup>13 | 18</sup> T. 31 N. R. 28 W. P.M.M. LINCOLN County

I. 1898 East and North boundaries of T31N, R29W by Paul S. A. Rickel: Set a slate stone, 18x12x8 ins., 12 ins. in the ground for cor. of secs. 13, 18, 19 & 24 and 4 bearing trees.

1972 BLM Remonumentation by Joseph E. French: The cor. of secs. 13, 18, 19 & 24, on the W. boundary of the Tp., monumented with a slate stone, 16x12x8 ins., set 12 ins. in the ground, mkd. 3 notches on the S. and N. edges, from which 2 of the original bearing trees:

- A fir, 28 ins. diam., bears S38°E, 45 lks. dist., mkd. T31N R28W S19 BT.
- A fir, 29 ins. diam., bears N31°10'W, 35 lks. dist., mkd. T31N R29W S13 BT.

At the corner point:

Set an iron post, 30 ins. long, 2 1/2 ins. diam., 24 ins. in the ground, with brass cap mkd. (shown below). From which new bearing trees:

- A larch, 8 ins. diam., bears N34°E, 56 lks. dist., mkd. T31N R28W S18 BT.
- A pine, 6 ins. diam., bears S51 1/4°W, 29 lks. dist., mkd. T31N R29W S24 BT.

bury the original stone alongside and raise a flat mound of stone, 3 1/2 ft. base around the iron post.

II. Found: A 2 1/2 in diam. iron pipe, firmly set in a collar of stone, with 3 1/4 in. diam. BLM brass cap, 2 ins. above ground, mkd. as shown below, from which:

- A larch, 13 ins. diam., bears N34°E, 37.0 ft. dist., mkd. with a healed face.
- A Douglas fir, 28 ins. diam., bears S38°E, 29.7 ft. dist., mkd. with a healed face.
- A pine, 12 ins. diam., bears S51°W, 19.1 ft. dist., mkd. with a healed face.
- A Douglas fir, 27 ins. diam., bears N31°W, 23.1 ft. dist., mkd. with a healed face.

III. Painted the scribed faces red and 6 in. wide red bands around the bearing trees. Attached Land Survey Monument and Bearing Tree signs. Set a 6 ft. steel post 3 ft. West, with "Land Survey Monument" and Property Boundary" decals attached.

LAT 48°26'33.51319"N  
LONG 115°14'10.28762"W  
NAD 83

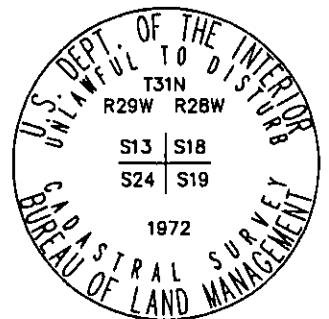

Date of Fieldwork: 5/3/2011  
Survey crew: Tom Hommel  
Magnetic declination: 20° East assumed  
Equipment used: Hand compass and loggers tape

U.S. Forest Service, Supervisors Office, 31374 Hwy. 2, Libby, MT 59923 (406) 293-6211

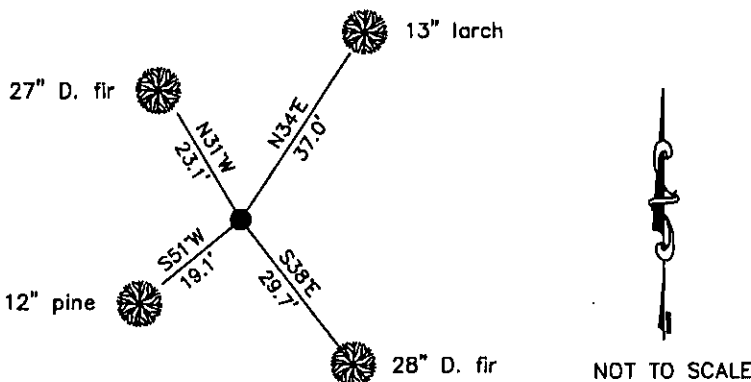

CERTIFICATION

I, Thomas M. Hommel, 10800LS  
certify that the information shown herein is true and correct.

*[Signature]*  
Signature of Surveyor & Seal

I, Marc Burkhart, 9520LS  
certify that this Corner Block correctly represents work performed by me or under my direction in compliance with the "Corner Registration Act" (M.C.A.)

*[Signature]*  
Signature of Surveyor & Seal

Date: 3/16/2012 License No. 9520LS  
Employer: U. S. Forest Service

Office of Clerk and Recorder, County of Lincoln

237811 BOOK: CCR CC&R'S PAGE: 11961 Pages: 1  
STATE OF MONTANA LINCOLN COUNTY  
RECORDED: 03/20/2012 8:38 KOI: CC&R'S  
TAMMY D. LAUER CLERK AND RECORDER  
FEE: \$0.00 BY *[Signature]*  
TO: US FOREST SERVICE 31374 HWY 2, LIBBY, MONTANA 59923,

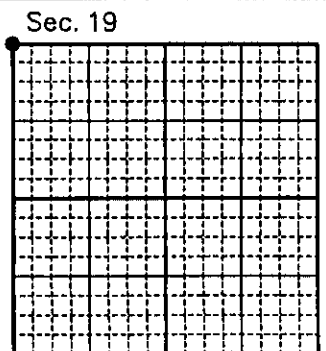

Cross Index No. N 1 T. 31N. R. 28W. P.M., MT

Adopted July 1, 1981, Montana Board of Professional Engineers & Land Surveyors

● corner this sheet