

CERTIFIED CORNER RECORDATION

CORNER CW 1/16 SEC. 26 T. 31N R. 26W, P.M.M., LINCOLN COUNTY

RECORD : NONE

FOUND: NOTHING.

SET: 5/8"x24" REBAR WITH YPC STAMPED AS SHOWN, FROM WHICH;  
11" FIR BEARS S34°E 15.30'.  
SET 5' STEEL POSTS 2 FEET EAST AND 4 FEET SOUTH OF CORNER.  
ATTACHED BT TAG AND PAINTED 6" BAND ON BT.

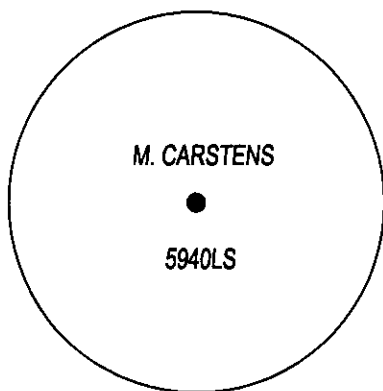
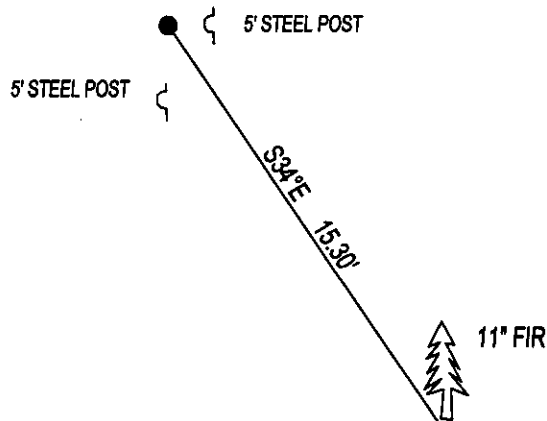

SKETCH OF CORNER

CERTIFICATION

I, DAN CROFT  
CERTIFY THE INFORMATION SHOWN HEREIN IS TRUE AND CORRECT.

SIGNATURE GROUND PARTY CHIEF

I, MARC J. CARSTENS  
CERTIFY THAT THIS CORNER RECORD CORRECTLY REPRESENTS WORK  
PERFORMED BY ME OR UNDER MY DIRECTION IN COMPLIANCE WITH THE  
"CORNER RECORDATION ACT" (70-22-101, ET SEQ., M.C.A.)

SIGNATURE OF SURVEYOR & SEAL

09-11-14

DATE

CARSTENS SURVEYING

EMPLOYER

5940LS  
REG. NO.

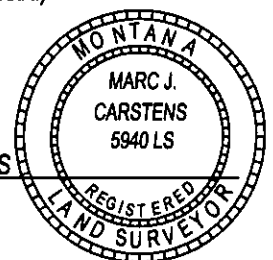

OFFICE OF CLERK AND RECORDER, COUNTY OF LINCOLN

THIS "CORNER RECORD" WAS FILED 253505 BOOK: CCR CC&R'S PAGE: 12132 Pages: 1

WAS NC STATE OF MONTANA LINCOLN COUNTY

AND IS ASSIGNED PAGE NO. RECORDED: 09/22/2014 9:50 KOI: CC&R'S

TAMMY D. LAUER CLERK AND RECORDER

COUNTY OFFICIAL

FEE: \$0.00

BY:

FOR: CARSTENS LAND SURVEYING P.O. BOX 1374, POLSON, MONTANA

CROSS INDEX NO. T-18 T. 31N R. 26W, P.M.M.

ADOPTED JULY 1, 1981, MONTANA BOARD OF PROFESSIONAL ENGINEERS & LAND SURVEYORS

SEC. 26

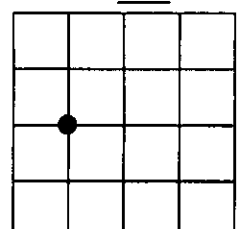

● CORNER THIS SHEET