

CERTIFIED CORNER RECORDATION

CORNER E1/4 SEC. 31 T. 31N R. 26W P.M.M., LINCOLN COUNTY

FOUND: 3 1/4" BRASS CAP STAMPED AS SHOWN FROM WHICH;
24" LARCH BEARS N28°W 18.50' WITH OVERGROWN BLAZE.

MAINTENANCE: BUILT A COLLAR OF STONE AROUND CORNER, FROM WHICH;
SET 5 FOOT STEEL POSTS 2 FEET WEST AND 2 FEET NORTH OF CORNER.
ATTACHED BT TAG AND PAINTED 6" BAND ON BT.

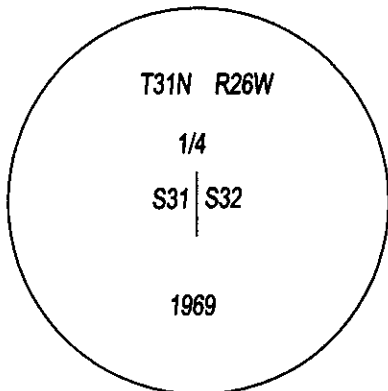
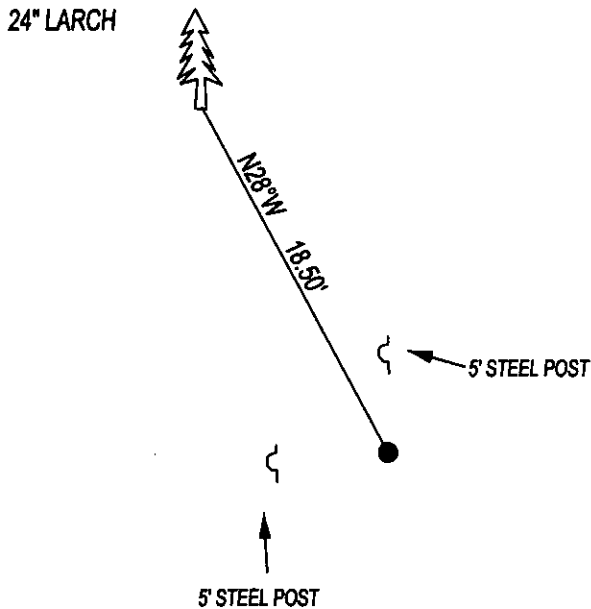

SKETCH OF CORNER

CERTIFICATION

I, DAN CROFT
CERTIFY THE INFORMATION SHOWN HEREIN IS TRUE AND CORRECT.

SIGNATURE GROUND PARTY CHIEF

I, MARC J. CARSTENS
CERTIFY THAT THIS CORNER RECORD CORRECTLY REPRESENTS WORK
PERFORMED BY ME OR UNDER MY DIRECTION IN COMPLIANCE WITH THE
"CORNER RECORDATION ACT" (70-22-101, ET SEQ., M.C.A.)



SIGNATURE OF SURVEYOR & SEAL

06-20-13

DATE

CARSTENS SURVEYING

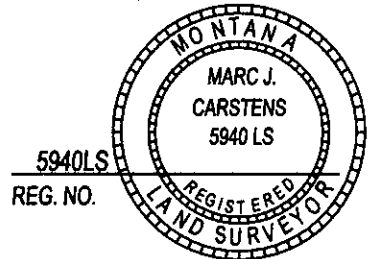
EMPLOYER



OFFICE OF CLERK AND RECORDER, COUNTY OF LINCOLN
THIS CORNER RECORD IS ASSIGNED PAGE 12042 OF BOOK 246001 CCR CC&R'S
STATE OF MONTANA LINCOLN COUNTY
RECORDED: 07/01/2013 12:02 KOI: CC&R'S
TAMMY D. LAUER CLERK AND RECORDER
FEE: \$0.00 BY: Glennie Dennis Deputy
FOR: CARSTENS LAND SURVEYING P.O. BOX 1374, POLSON, MONTANA
CROSS INDEX NO. X-5 T. 31N R. 26W P.M.M.
ADOPTED JULY 1, 1981, MONTANA BOARD OF PROFESSIONAL ENGINEERS & LAND SURVEYORS

