

CERTIFIED CORNER RECORDATION

Corner S W Sec. Cor. S 36 T. 31 N., R. 26 W., P.M.M. Lincoln County

Record :

1932 original GLO notes by Ernest Parker.

Set an iron post, 3 ft. long, 2 ins. diam. , 28 ins. in the ground, with brass cap.

A tamarack, 6 ins. diam., bears N. $11 \frac{1}{2}^{\circ}$ E., 67 lks. dist., marked T 31 N R 26 W S 36 B T.

A fir, 14 ins. diam., bears N. $21 \frac{1}{2}^{\circ}$ W., 80 lks. dist., marked T 31 N R 26 W S 35 B T.

Found Evidence :

Found iron pipe with brass cap.
No evidence of Bearing Trees were found.

Perpetuation :

Established the following new Bearing Trees:

A douglas fir, 5 ins. diam., bears N. 07° E., 32.1 ft. dist., marked "x" BT for Sec. 36.

A grand fir, 14 ins. diam., bears N. 85° W., 40.9 ft. dist., for Sec. 35.

Painted 6 in. wide red bands around both Bearing Trees and attached Bearing Tree and warning signs.

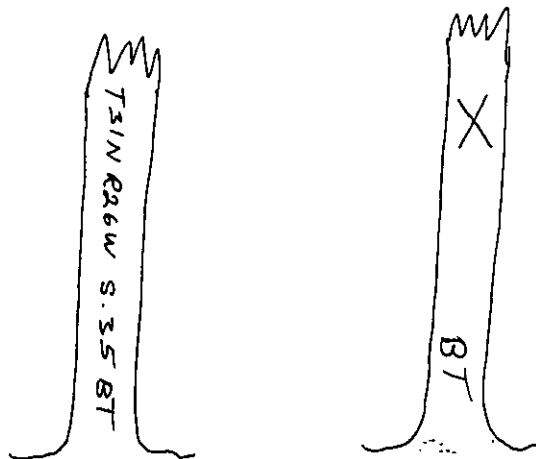

Magnetic Declination: 17° E.

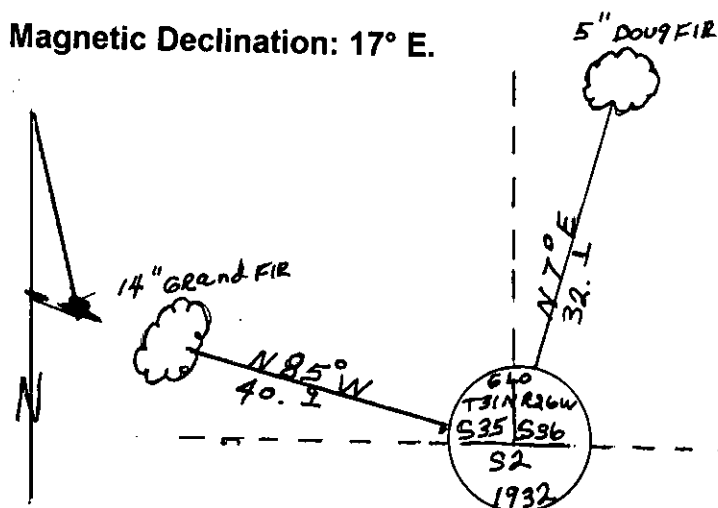

Sketch of Corner

CERTIFICATION

I, Ricky E. Shaver

certify the information shown herein is true and correct

Ricky E. Shaver
Signature of Ground Party Chief

I, Kenneth E. Davis

certify that this corner record correctly represents work performed by me in the direction of compliance with the "Corner Recordation Act"

(10-22-18) KENNETH E. DAVIS

Kenneth E. Davis

Signature of Surveyor & Seal

Date of Survey 2/28/2002 No. W 4976-S

Employer Davis Surveying, Inc.

Section

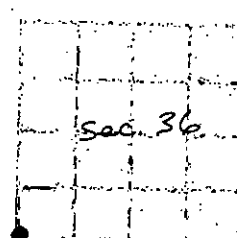

Office of Clerk and Recorder, County of Lincoln
This "corner record" was filed for record on 2/28/2002
was noted on the cross-index plat and is assigned page No. 10428
in book No. Coral M. Cumming By Pub
County Official

Cross Index No. S W Sec. Cor. S 36 T. 31 N., R. 26 W., PMM

• THIS CORNER