

CERTIFIED CORNER RECORDATION

Corner W 1/4 S 31 T. 31 N., R. 25 W., P.M.M. Lincoln County

Record :

1932 original GLO notes by Ernest Parker.

Set an iron post, 3 ft. long, 1 in. diam., 28 ins. in the ground, for 1/4 sec. cor. of Sec. 31 only, with brass cap.

A fir, 4 ins. diam., bears N. 67 1/4° E., 6 lks. dist., marked 1/4 S 31 B T.

A fir, 4 ins. diam., bears S. 56° W., 18 lks. dist., marked 1/4 S 31 B T.

Found Evidence :

Found original iron pipe with brass cap.

Found original fir (face grown over), 9 ins. DBH, bearing N. 67 1/4° E., 6 lks. dist.

Perpetuation :

Established the following new Bearing Tree:

A pine, 6 1/2 ins. DBH, bears S. 70° E., 10.0 ft. dist., scribed T31N R25W S31 1/4 BT.

Painted 6 in. wide red bands around both Bearing Trees and attached Bearing Tree and warning signs.

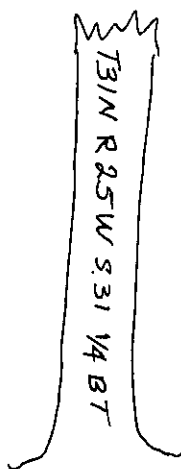

Magnetic Declination: 17° E.

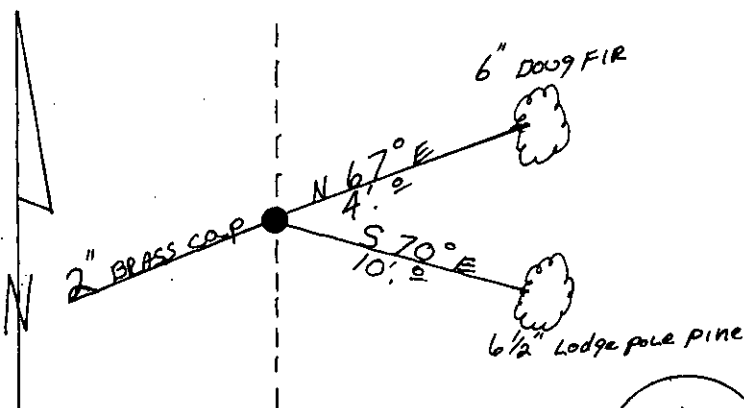

Sketch of Corner

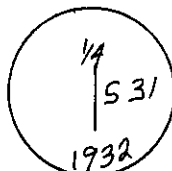

CERTIFICATION

I, George Clark  
certify the information shown herein is true and correct

Signature of Party Chief

I, Kenneth E. Davis

certify that this Corner Record correctly represents work performed by me or under my direction in compliance with the "Corner Recordation Act"

**KENNETH E. DAVIS**  
74-12-101, S.A.V.S.M.S.A.  
1975 S  
Date: 2/28/2000 Reg. No. 4975-S  
Employer: Lawson Surveying, Inc.

Office of Clerk and Recorder, County of Lincoln

This "corner record" was filed for record on 2/28/2000  
was noted on the cross-index plat and is assigned page No. 10425

in book No. \_\_\_\_\_  
Neal M. Cummins  
County Official

Section

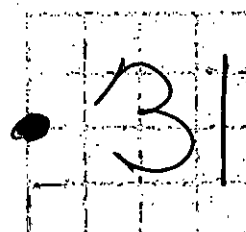

Cross Index No. W 1/4 S 31 T. 31 N., R. 25 W., PMM

● THIS CORNER