

## INSTRUCTIONS

1. Original and/or subsequent record used to evaluate the corner position.
2. Description of evidence found, note discrepancies in the record, state method of establishing lost or obliterated corners.
3. Description of monument and accessories set to perpetuate the corner position.
4. Sketch of corner, show all pertinent data which can best be shown in a sketch example, corner marking, topography ties, position of accessories, etc.
5. Certification must be signed and sealed by Land Surveyor registered in the State of Montana.
6. Fill in Cross Index & Section Diagram at bottom of sheet.

## CERTIFIED CORNER RECORDATION

Corner Angle Point 2 of MS 7655, 7656 T. 30 N. R. 34 W. P.M.M. Lincoln County

I. No previous record, not set.

II. No evidence found.

III. At the calculated position. (See certificate of survey filed in Lincoln County courthouse) set a  $\frac{3}{4}$  in. diam., 30 ins. long, alum. rod 26 ins. in the ground with alum. cap mkd. as shown.

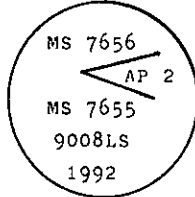

From which:

- A fir, 15 ins. diam., bears  $N63^{\circ}E$ , 16.8 ft. dist., mkd. AP 2 BT.  
 A fir, 5 ins. diam., bears  $N22^{\circ}W$ , 29.4 ft. dist., mkd. AP 2 BT.

Painted red bands around the bearing trees and attached "Land Survey Monument" and "Bearing Tree" signs.

Set a galvanized steel guard post with "Land Survey Marker" and "Property Boundary" decals, East, 3 ft.  
 Magnetic declination:  $20^{\circ}$  East

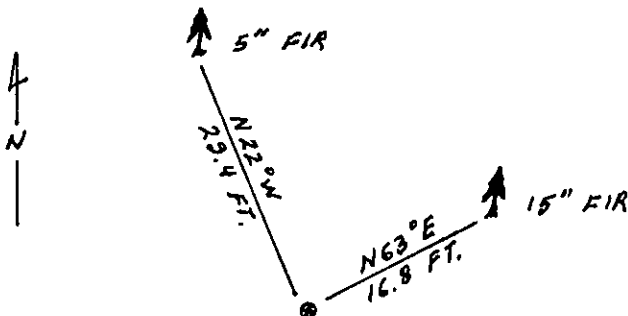
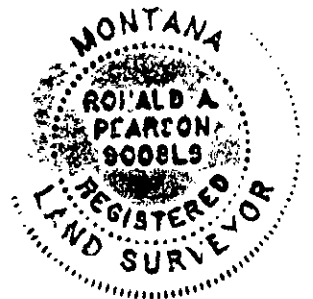

SKETCH OF CORNER

## CERTIFICATION

I, Kevin A. Todd  
 certify the information shown herein is true and correct.  
Kevin A. Todd  
 Signature Ground Party Chief  
 I, Ronald A. Pearson  
 certify that this Corner Record correctly represents work performed  
 by me or under my direction in compliance with the "Corner  
 Recordation Act" (70-22-101, et seq., M.C.A.)  
Ronald A. Pearson  
 Signature of Surveyor & Seal  
 Date: 11/23/92 Reg. No. 9008 LS  
 Employer: U.S. FOREST SERVICE

Office of Clerk and Recorder, County of Lincoln. This "corner  
 record" was filed for record on 12-15-92  
 was noted on the cross-index plat and is assigned page No. 5184, in  
 book No. Coral M. Cummings by 150

County Official

Cross Index No. AP 2 MS 7656 T. 30 N R. 34 W PMM

Sec. 10

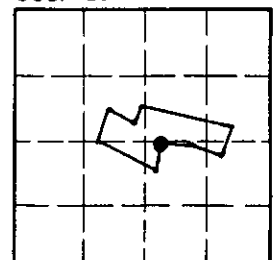

• - corner this sheet