

INSTRUCTIONS

1. Original and/or subsequent record used to evaluate the corner position.
2. Description of evidence found, note discrepancies in the record, state method of establishing lost or obliterated corners.
3. Description of monument and accessories set to perpetuate the corner position.
4. Sketch of corner, show all pertinent data which can best be shown in a sketch example, corner marking, topography ties, position of accessories, etc.
5. Certification must be signed and sealed by Land Surveyor registered in the State of Montana.
6. Fill in Cross Index & Section Diagram at bottom of sheet.

CERTIFIED CORNER RECORDATION

Corner 1/4 Cor. of Secs. 2 & 11 T. 30 N. R. 34 W. P.M.M. Lincoln County

- I. 1913 original, G.L.O. record by Lewellyn D. Lyman et al: "Set a slate stone, 16x7x7 ins., 11 ins. in the ground for 1/4 sec. cor., marked 1/4 on N. face; from which

A cedar, 10 ins. diam., bears S22°15'E, 28 lks. dist., marked 1/4 S11 BT.
A hemlock, 12 ins. diam., bears N27°E, 21 lks. dist., marked 1/4 S2 BT."

- II. Found a stone, 6x5x16 ins., lying loosely on the ground, mkd. 1/4 on one face, from which

A cedar stump, 12 ins. diam., bears S19°E, 18.48 ft. (28 lks.) dist., mkd. "1/4 S11 BT".
A dead hemlock, 11 ins. diam., bears N25°E, 13.86 ft. (21 lks.) dist., visible scribe.

- III. At record distance - distance intersect from original bearing trees, set a 2 1/2 ins. dia. aluminum pipe, 30 ins. long, 24 ins. in the ground with attached 3 1/4 ins. dia. U.S.D.A. Forest Service aluminum cap, marked as shown:

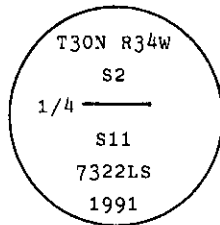

Establish two new bearing tree:

A cedar, 10 ins. dia., bears S15°W, 16.9 ft. dist., mkd. 1/4 S11 BT.
A larch, 20 ins. dia., bears N32°W, 4.5 ft. dist., mkd. 1/4 S2 BT.BT.

Set a 6 ft. galvanized steel guard post with "Survey Marker" decal attached, 3 ft. North.

Painted a red band around each bearing tree and attached "Land Survey Monument" & "Bearing Tree" signs.

Magnetic Declination: East, 20°

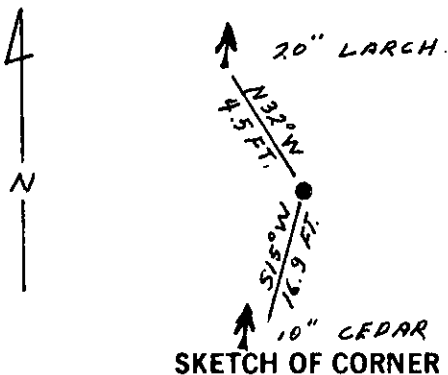

CERTIFICATION

I. Kevin A. Todd
certify the information shown herein is true and correct.

Kevin A. Todd
Signature Ground Party Chief

I. Alvah F. Hughes
certify that this Corner Record correctly represents work performed by me or under my direction in compliance with the "Corner Recordation Act" (70-22-101 et seq., M.C.A.).

Alvah F. Hughes
Signature of Surveyor & Seal

Date: 11/6/91 Reg. No. 7322 LS

Employer: U.S. FOREST SERVICE

Office of Clerk and Recorder, County of Lincoln. This "corner record" was filed for record on 4-22-92 was noted on the cross-index plat and is assigned page No. 5054 in book No. Local in. Cummings

County Official

E19

30 N

34 W

Cross Index No. _____ T. _____ R. _____ PMM

Sec. 2

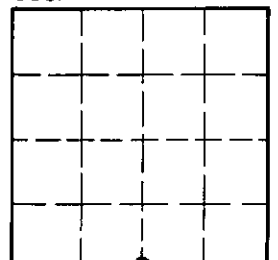

• - corner this sheet