

INSTRUCTIONS

1. Original and/or subsequent record used to evaluate the corner position.
2. Description of evidence found, note discrepancies in the record, state method of establishing lost or obliterated corners.
3. Description of monument and accessories set to perpetuate the corner position.
4. Sketch of corner, show all pertinent data which can best be shown in a sketch example, corner marking, topography (ies), position of accessories, etc.
5. Certification must be signed and sealed by Land Surveyor registered in the State of Montana.
6. Fill in Cross Index & Section Diagram at bottom of sheet.

CERTIFIED CORNER RECORDATION

Corner of Secs. 11, 12, 13 & 14 T. 30 N., R. 34 W., P.M.M. Lincoln County

I. 1913 original, G.L.O. record by Lewellyn D. Lyman et al: "Set a quartzite stone, 15x10x10 ins., 10 ins. in the ground, for cor. of secs. 11, 12, 13 and 14, marked with 4 notches on S., and 1 notch on E. edge, raise a mound of stone, 2 ft. base, 1 1/2 ft. high, w. of cor.

II. Found a firmly set stone, 5x8x15 ins., mkd. 4 notches on S. and 1 notch on E. edges from which

A mound of stone, 2 ft. dia., 1/2 ft. high, bears West.

III. Replaced stone monument with a 2 1/2 ins. dia. aluminum pipe, 30 ins. long, 24 ins. in the ground with attached 3 1/4 ins. dia. U.S.D.A. Forest Service aluminum cap, marked as shown:

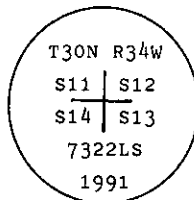

Establish four new bearing tree:

A ponderosa pine, 14 ins. dia., bears N24° E, 27.9 ft. dist., mkd. T30N R34W S12 BT.

A douglas fir, 13 ins. dia., bears S59° E, 11.3 ft. dist., mkd. T30N R34W S13 BT.

A douglas fir, 12 ins. dia., bears S84° W, 33.7 ft. dist., mkd. T30N R34W S14 BT.

A douglas fir, 14 ins. dia., bears N51° W, 15.0 ft. dist., mkd. T30N R34W S11 BT.

Painted a red band around each bearing tree and attached "Land Survey Monument" & "Bearing Tree" signs.

Bury original stone monument alongside aluminum pipe.

Magnetic Declination: East, 20°

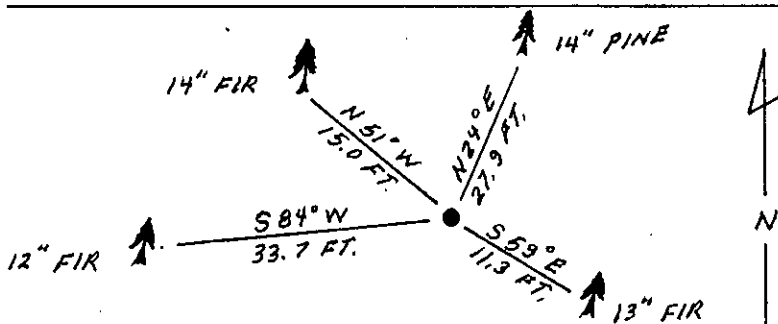

SKETCH OF CORNER

CERTIFICATION

I, Kevin A. Todd
certify the information shown herein is true and correct.

Kevin A. Todd
Signature Ground Party Chief

I, Alvah F. Hughes
certify that this Corner Record correctly represents work performed by me or under my direction in compliance with the "Corner Recordation Act" (70-22-101, et seq., M.C.A.).

Alvah F. Hughes
Signature of Surveyor & Seal

Date: 11/6/91 Reg. No. 7322LS

Employer: U.S. FOREST SERVICE

Office of Clerk and Recorder, County of Lincoln. This "corner record" was filed for record on 4-22-92 was noted on the cross-index plat and is assigned page No. 5049, in book No. Coral v. Summers

County Officer [Signature]

J21 30 N 34 W
Cross Index No. T. R. PMM

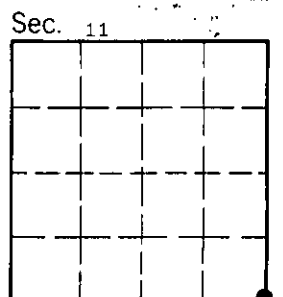

• - corner this sheet