

- INSTRUCTIONS
1. Original and/or subsequent record used to evaluate the corner position.
 2. Description of evidence found, note discrepancies in the record, state method of establishing true or unaltered corners.
 3. Description of monument and accessories set to perpetuate the corner position.
 4. Sketch of corner, show all pertinent data which can best be shown in a sketch example, corner marking, topography lines, position of accessories, etc.
 5. Certification must be signed and sealed by Registered Land Surveyor in State of Montana.
 6. Fill in Cross Index & Section Diagram at bottom of sheet.

CERTIFIED CORNER RECORDATION

Corner C-N-N-SW 1/256 Sec. 24 T. 30N R. 34W P.M.M. LINCOLN County

No record or evidence of corner being previously set.

I position corner from found section and quarter corners and as shown on the Certificate of Survey as filed and of record in the Lincoln Co. Courthouse.

I set a 3" alum. cap for corner position, from which:

A 20" cedar bears S66°W, 13.1', scribed C-N-N-SW 1/256 S24 BT

A 24" cedar bears N24½°W, 19.4', scribed C-N-N-SW 1/256 S24 BT

Painted red bands around BT's and painted the blazes red.
Posted BT, Attention, and Locations signs.

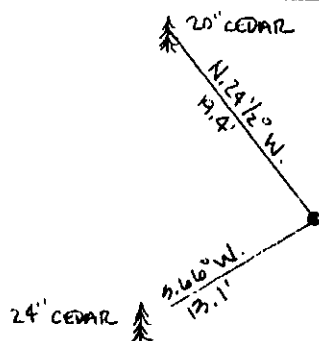
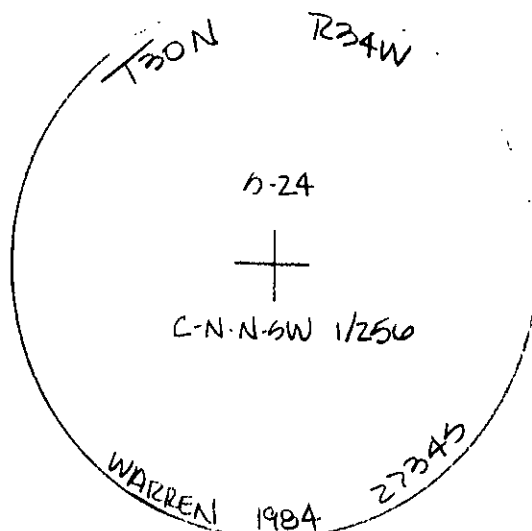

SKETCH OF CORNER

CERTIFICATION

I, GLENN KNODLE
certify the information shown herein is true and correct.

Glenn Knodle
Signature Ground Party Chief

I, J. GENE WARREN
certify that this Corner Record correctly represents work performed by me or under my direction in compliance with the "Corner Recordation Act" (70-22-101, et seq., M.D.A.)

J. Gene Warren
Signature of Surveyor & Seal

Date: 9/84 Reg. No. 27345

Employer: Rocky Mountain Surveys

Office of Clerk and Recorder, County of LINCOLN. This "corner record" was filed for record on the NOV 30 day of 1984 was noted on the cross-index plat and is assigned page No. 2790, in

book No. _____

Janet BF Siegel by Betty Conner
County Official deputy

T30N R34W PMMM

Sec. 24

