

- INSTRUCTIONS
1. Original and/or subsequent record used to evaluate the corner position.
  2. Description of evidence found, note discrepancies in the record, state method of establishing lost or obliterated corners.
  3. Description of instrument and accessories set to perpetuate the corner position.
  4. Sketch of corner, show all pertinent data which can best be shown in a sketch example, corner marking, topography ties, position of accessories, etc.
  5. Certification must be signed and sealed by Registered Land Surveyor in State of Montana.
  6. Fill in Cross Index & Section Diagram at bottom of sheet.

## CERTIFIED CORNER RECORDATION

Corner N-S-S 1/256 Sec. 24 T. 30N R. 34W P.M.M. LINCOLN County

No record or evidence of corner being previously set.

I position corner from found section and quarter corners and as shown on the Certificate of Survey as filed and of record in the Lincoln Co. Courthouse.

I set a 3" alum. cap for corner position, from which:

A 7" pine bears S5° W, 80.52', scribed N-S-S 1/256 S23 BT  
Scribed "X" in curb at SW Corner of bridge bears N62° E, 17.0'

Painted a red band around BT and painted the blaze red.  
Posted BT, Attention, and Location signs.

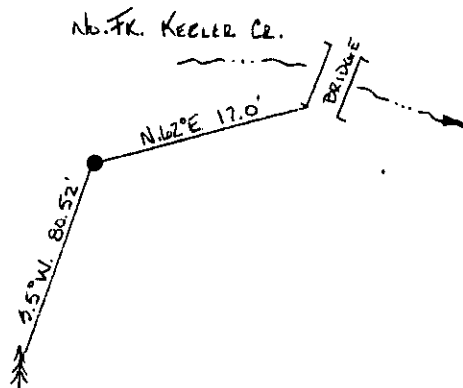
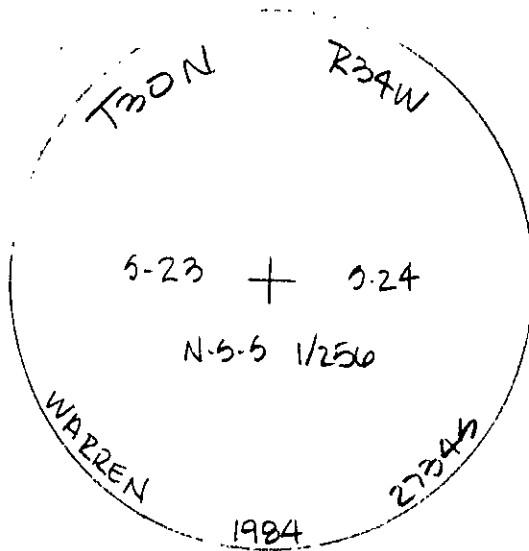

SKETCH OF CORNER

CERTIFICATION

I, GLENN KNODLE  
certify the information shown herein is true and correct.  
Glenn Knodle  
Signature Ground Party Chief

I, H. GENE WARREN  
certify that this Corner Record correctly represents work performed by me or under by direction in compliance with the "Corner Recordation Act" (70-22-101, et seq., M.D.A.)  
H. Gene Warren  
Signature of Surveyor & Seal

Date: 9/84 Reg. No. 27345  
Employer: Rocky Mountain Surveyors

Office of Clerk and Recorder, County of LINCOLN. This "corner record" was filed for record on the NOV. 30 day of 1984 was noted on the cross-index plat and is assigned page No. 2785, in book No. \_\_\_\_\_

Janet BF Siegel by Betty Conces  
County Official deputy

