

INSTRUCTIONS

1. Original and/or subsequent record used to evaluate the corner position.
2. Description of evidence found, note discrepancies in the record, state method of establishing lost or obliterated corners.
3. Description of monument and accessories set to perpetuate the corner position.
4. Sketch of corner, show all pertinent data which can best be shown in a sketch example, corner marking, topography ties, position of accessories, etc.
5. Certification must be signed and sealed by Land Surveyor registered in the State of Montana.
6. Fill in Cross Index & Section Diagram at bottom of sheet.

CERTIFIED CORNER RECORDATION

Corner 15 | 14
22 | 23 T. 30N R. 34W P.M.M. Lincoln County

I. 1913 GLO Record: Set a quartzite stone, 15x14x10ins., 10ins. in the ground, for the cor. of secs. 14, 15, 22 and 23, marked with 3 notches on s. and 2 notches on e. edge; raise a mound of stone, 2 ft. base and 1½ ft. high, w. of corner, from which:

A tamarack 30 ins. diam., bears S.81°15'E., 517 lks. dist., marked T30N R34W S23 BT..

A tamarack, 12 ins. diam., bears S.57½°W., 349 lks. dist., marked T30N R34W S22 BT..

1957 BLM remonumentation: The cor. of secs. 14, 15, 22 and 23 mkd. by a quartzite stone 24x12x8ins. firmly set with 2 grooves on E. and 4 grooves on S. faces, witnessed by a mound of stone 3ft. base, 3½ft. W. of corner.

At the corner point

Set an iron post, 2½in. diam., 30ins. long, 29ins. in the ground, with a brass cap mkd.

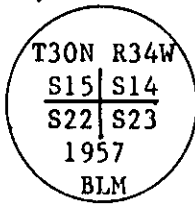

from which:

A pine, 8in. diam., bears N.15½°W., 101 lks. dist., mkd. T30N R34W S15 BT

A pine, 6in. diam., bears N.39½°E., 91 lks. dist., mkd. T30N R34W S14 BT

Note: The stone sizes and the stone markings of the remonumentation survey do not match the original 1913 survey, the reason for this discrepancy is unknown.

II. I found a 2½in. diam. BLM brass cap on an iron pipe 2ins. out of the ground, from which:

A pine, 20in. diam., bears N.15°W., 66.6 ft. dist., healed face.

A pine, 26in. diam., bears N.40°E., 60.4 ft. dist., healed face.

I posted new BT signs on BT's, and attached a location poster 420 ft. E. on road # 404.

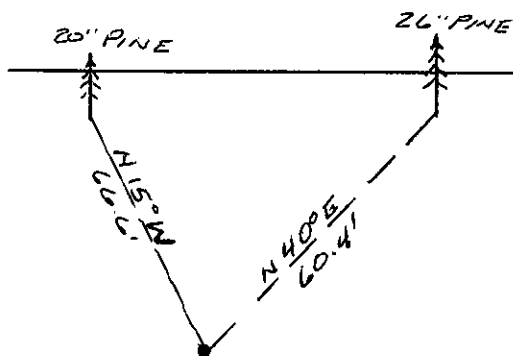

SKETCH OF CORNER



CERTIFICATION

I, Ronald Pearson
certify the information shown herein is true and correct.
Ronald Pearson
Signature Ground Party Chief

I, Thomas C. Hill
certify that this Corner Record correctly represents work performed by me or under my direction in compliance with the "Corner Recordation Act" (70-22-101, et seq., M.C.A.)
Thomas C. Hill
Signature of Surveyor & Seal

Date: 6/14/84 Reg. No. 5612S

Employer: U.S.F.S.

Office of Clerk and Recorder, County of Lincoln. This "corner record" was filed for record on July 12, 1984 was noted on the cross-index plat and is assigned page No. 2688, in book No. _____
Janet L. Sigel by Jeannie Dennis
County Official Deputy

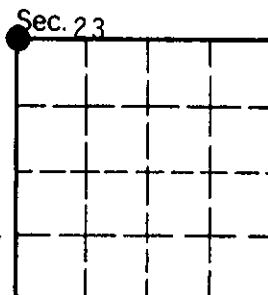

• - corner this sheet