

INSTRUCTIONS

1. Original and/or subsequent record used to evaluate the corner position.
2. Description of evidence found, note discrepancies in the record, state method of establishing lost or obliterated corners.
3. Description of monument and accessories set to perpetuate the corner position.
4. Sketch of corner, show all pertinent data which can best be shown in a sketch example, corner marking, topography ties, position of accessories, etc.
5. Certification must be signed and sealed by Land Surveyor registered in the State of Montana.
6. Fill in Cross Index & Section Diagram at bottom of sheet.

CERTIFIED CORNER RECORDATION

Corner Cor. 4 Hes 577 T. 30N R. 34W P.M.M. Lincoln County

1917 GLO Record: set a small stone, with a cross(X) under a quartzite stone 24x 9x6in., 14in. in the ground, mkd. CC 4 HES 577 on NW face and a cross(x) on top for exact corner point.

from which:

A cross(x) on a yellow pine, 22ins. diam., bears N.19°45'E., 109 lks.dist.

A cross(x) on a yellow pine, 24ins. diam., bears east, 153 lks. dist.

Each blazed and scribed 4 HES 577 BT.

Raise a mound of earth 4 ft. base and 2 ft. high, NW of corner.

II. I found a 24x9x6in. stone, 10in. exposed with CC 4 HES 577 on NW face.

from which:

A pine snag, 21ins. diam., bears N.22°E., 72 ft. dist., scribing visable.

A rotten stump, bears east 101 ft., no visable scribes.

III. I set a 2in. diam. by 30in. long aluminum pipe with a 3/4in. diam. aluminum cap surrounded by stone collar and mkd. as shown. Bury orig. stone alongside pipe.

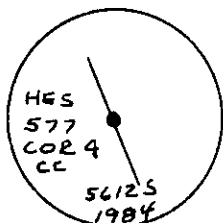

from which the new BT's:

A larch, 13in. diam., bears S.71°E., 10.6 ft. dist., scribed 4 HES 577 BT.

A fir, 15in. diam., bears N.16°E., 20.2 ft. dist., scribed 4 HES 577 BT.

Painted red bands around all BT's and attached new BT signs. Set a 6 ft. galvanized post 2 ft. in the ground 2 ft. NE of corner.

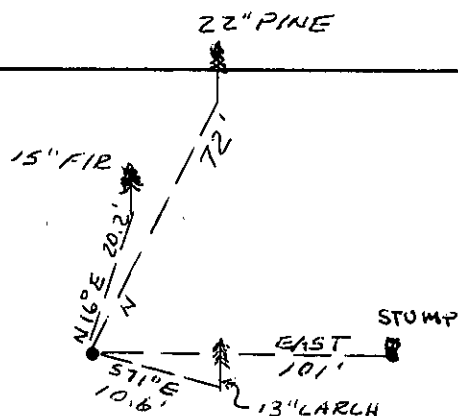

SKETCH OF CORNER



CERTIFICATION

1. James W Reed

certify the information shown herein is true and correct.

James W Reed
Signature Ground Party Chief

1. Thomas C. Hill

certify that this Corner Record correctly represents work performed by me or under my direction in compliance with the "Corner Recordation Act" (70-22-101, et seq., M.C.A.)

Thomas C Hill
Signature of Surveyor & Seal

Date: 6/21/84 Reg. No. 5612S

Employer: U.S.F.S.

Office of Clerk and Recorder, County of Lincoln. This "corner record" was filed for record on July 12, 1984 was noted on the cross-index plat and is assigned page No. 2686, in book No. _____

Janet B. Sigel by Thomas C. Hill
County Official Deputy

Cross Index No. _____ T. 30N R. 34W PMM
Adopted July 1, 1981, Montana Board of Professional Engineers & Land Surveyors

Sec. 14

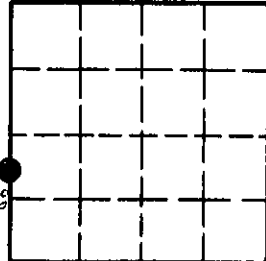

• - corner this sheet