

CERTIFIED LAND CORNER RECORDATION
(REFERENCE FSM 7153.53)

DESCRIPTION OF CORNER EVIDENCE FOUND, AND ORIGINAL RECORD (IF KNOWN)

DESCRIPTION OF MONUMENT AND ACCESSORIES ESTABLISHED
TO PERPETUATE THE ORIGINAL LOCATION OF THIS CORNER:

Date of work: 10/1/80

Set standard aluminum post & cap 24" in the ground.

Bearing trees;

16" Larch N. 50° 30' E. 17.8 feet Mkd. NE 1/16 S 26 BT
13" Cedar N. 85° E. 28.8 feet Mkd. NE 1/16 S 26 BT

Bearing tree tags affixed & Location poster

Brass tags ~~###~~ set at base of BTs at root crown distance from corner.
2968 S

SKETCH, WITH COURSE AND DISTANCE TO ADJACENT CORNERS IF DETERMINED IN THIS SURVEY.
(MAY SKETCH OR PASTE REPRODUCTION ON REVERSE SIDE.)

See Survey Plat, South Fork Keefer, T. 30 N., R. 34 W., P.M.

Surveyor's Seal

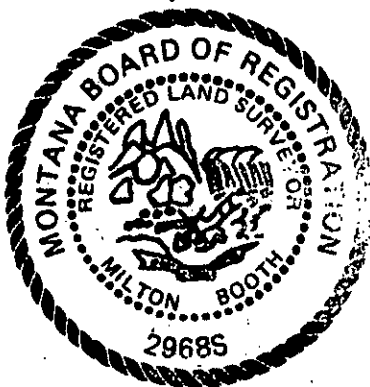

I, _____
certify that the information shown herein is true and
correct.

Signature of Ground Party Chief

I, Milton I. Booth
certify that I have carefully performed or reviewed the
work done on the diagrammed corner as reported on this
recording form and approve the same.

Milton I. Booth
Signature of Surveyor

2968 S
Registration Number

DIAGRAM OF CORNER:

N.

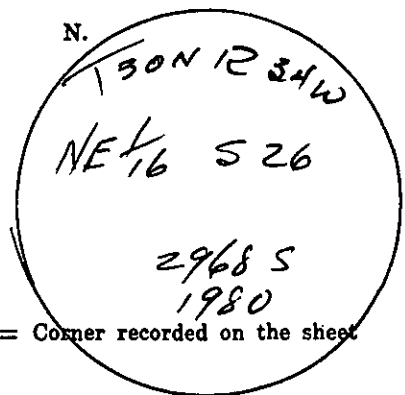

Office of Clerk and Recorder, County of Lincoln

This "corner record" was filed for record on the 1st day of September, 1981, was noted on the cross-index plat and is
assigned page No. 1195, in book No. 1

Charles L. Thompson, Jr., Deputy Clerk
County Official

Cross Index No. 5-20 T. 30 N. R. R34W P. Mer.