

- INSTRUCTIONS
1. Original and subsequent record used to evaluate the corner position.
 2. Description of evidence found, note discrepancies in the record, state method of establishing lost or obliterated corners.
 3. Description of monument and accessories set to perpetuate the corner position.
 4. Sketch of corner, show all pertinent data which can best be shown in a sketch example, corner marking, topography ties, position of accessories, etc.
 5. Certification must be signed and sealed by Land Surveyor registered in the State of Montana.
 6. Fill in Cross Index & Section Diagram at bottom of sheet.

CERTIFIED CORNER RECORDATION

Corner CE 1/16 Section 20 T. 30 N. R. 33 W. P.M.M. Lincoln County

I. DAVIS SURVEYING, INC. 1992 (June)

I set a 5/8 inch, dia. x 24 inch long rebar with a 1 1/4 inch dia. plastic cap stamped: KED 4975 S

FROM WHICH:

An 8 inch DBH Cedar bears S 52°E 14.75 feet from the center of the tree, scribed: CE 1/16 S 20 BT (Notch at Root Crown)

A 9 inch DBH Cedar bears S 60°W 15.49 feet from the center of the tree, scribed: CE 1/16 S 20 BT (Notch at Root Crown)

MAINTENANCE:

Painted BT and Land Survey Monument signs.

Painted blazes red.

Painted a red band around the tree above the BT sign.

Set a steel post with Land Survey Marker Sticker 1 foot North of the corner.

Declination = 20° E

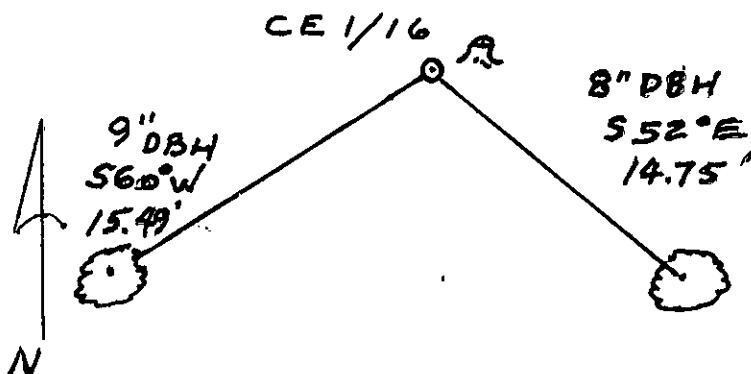

SKETCH OF CORNER

CERTIFICATION	
I, <u>Kent Davis</u>	
certify the information shown herein is true and correct.	
<u>Kent Davis</u>	
Signature Ground Party Chief	
I, <u>Kent Davis</u>	
certify that this Corner Record correctly represents work performed by me or under my direction in compliance with the "Corner Recordation Act" (70-22-101, et seq., M.C.A.)	
<u>Kent Davis</u>	
Signature of Surveyor & Seal	
Date: <u>6/12</u>	Reg. No. <u>4975 S</u>
Employer: <u>Davis Surveying, Inc.</u>	

Office of Clerk and Recorder, County of Lincoln This "corner

record" was filed for record on OCT 14, 1992

was noted on the cross-index plat and is assigned page No. 5097, in

book No. _____

Carol M Cummings by Lois Buckoff
County Official

Cross Index No. _____ T. _____ R. _____ PMM

Adopted July 1, 1981, Montana Board of Professional Engineers & Land Surveyors

Sec. <u>20</u>			

• - corner this sheet