

## INSTRUCTIONS

1. Original and/or subsequent record used to evaluate the corner position.
2. Description of evidence found, note discrepancies in the record, state method of establishing lost or obliterated corners.
3. Description of monument and accessories set to perpetuate the corner position.
4. Sketch or corner, show all pertinent data which can best be shown in a sketch example, corner marking, topography ties, position of accessories, etc.
5. Certification must be signed and sealed by Registered Land Surveyor in State of Montana.
6. Fill in Cross Index & Section Diagram at bottom of sheet.

## CERTIFIED CORNER RECORDATION

Corner NW 1/16 th. Sec. 19 T. 30 N. R. 33 W. P.M.M. Lincoln County

Set 5/8" x 18" steel rebar with yellow P.V.C. cap stamped KED 4975 S for NW 1/16 corner. From which I scribed and marked two new bearing trees.

- 1) A larch 7 inches in dia. bears N 87° 30' E 56.4 feet in distance, scribed NW 1/16 S 19 Bt.
- 2) A lodgepole pine 7 inches in dia. bears N 0° 30' W, 27.2 feet in distance, scribed NW 1/16 S 19 Bt.

Painted the face scribe and red bands around each bearing tree and attached a bearing tree sign on each.

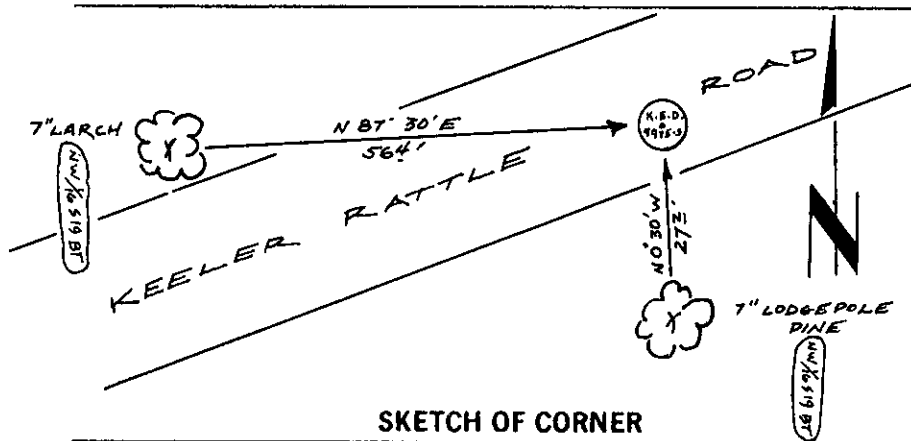

SKETCH OF CORNER

## CERTIFICATION

I, KENNETH E. DAVIS  
certify the information shown herein is true and correct.

Kenn E Davis  
Signature of Ground Party Chief

I, Kenn E Davis  
certify that this Corner Record correctly represents work performed by me or under my direction in compliance with the "Corner Recordation Act" (70-22-101, et seq., M.D.A.)

Kenn E Davis  
Signature of Surveyor & Seal

Date: Feb 23 Reg. No. 4975 S

Employer: Davis Surveying INC

Office of Clerk and Recorder, County of Lincoln. This "corner record" was filed for record on the Feb 24 day of 1989 was noted on the cross-index plat and is assigned page No. 3982, in book No. \_\_\_\_\_

Don B. Sigel by Bill Sigel  
County Official

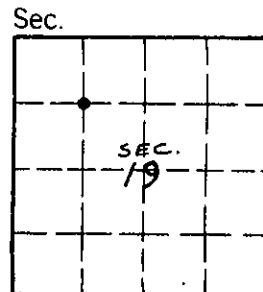

Cross Index No. \_\_\_\_\_ T. \_\_\_\_\_ R. \_\_\_\_\_ PMM

• - corner this sheet