

INSTRUCTIONS

1. Original and/or subsequent record used to evaluate the corner position.
2. Description of evidence found, note discrepancies in the record, state method of establishing lost or obliterated corners.
3. Description of monument and accessories set to perpetuate the corner position.
4. Sketch or corner, show all pertinent data which can best be shown in a sketch example, corner marking, topography ties, position of accessories, etc.
5. Certification must be signed and sealed by Registered Land Surveyor in State of Montana.
6. Fill in Cross Index & Section Diagram at bottom of sheet.

CERTIFIED CORNER RECORDATION

Corner C-S-S 1/64 Section 29 T. 30N. R. 33W. P.M.M. Lincoln County

I. 1986 Davis Surveying Inc.

I set a 5/8 inch dia. x 24 inch long rebar with Yellow PVC Cap Stamped; K.E.D. 4975 S. from which;

A red fir, 7 inches DBH, bears S.25*W., 14.9 feet from center of tree. Scribed: S29 BT with a notch at root crown.

A red fir, 6 inches DBH, bears S.30*E., 18.4 feet from center of tree. Scribed: S29 BT with a notch at root crown.

Painted a 6 inch wide red band around BTs with BT signs on front and warning signs #54.9 on back.

Set a steel fence post 1 foot west of corner.

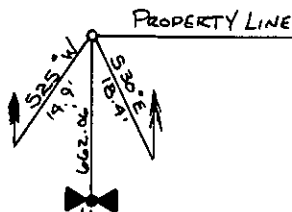

SKETCH OF CORNER

CERTIFICATION

I, Ken Davis
certify the information shown herein to be true and correct.

Ken Davis
Signature Ground Party Chief
KENNETH E. DAVIS
I, Ken E. Davis
certify that this Corner Record correctly represents work performed by me or under my direction in compliance with the "Corner Recordation Act" 70-22-101, et seq., M.C.S. REGISTERED LAND SURVEYOR

Date: 9/86 Reg. No. 4975 S.
Employer: Davis Surveying Inc.

Office of Clerk and Recorder, County of Lincoln. This "corner record" was filed for record on the Sept 4 day of 1986 was noted on the cross-index plat and is assigned page No. 3339, in book No. _____

Janet BT Signer by Bill Bradford
County Official Deputy

Sec. 29
