

CERTIFIED CORNER RECORDATION

Corner NS 1/64 S2|S1 T. 30 N. R. 34 W. P.M.M. Lincoln County

I. Record: None

II. Found: No record monuments found.

III. Perpetuation: At the corner point, determined by survey, set a 5/8 ins. diam. steel rebar 30 ins. long, 28 ins. in the ground, with a 3 1/4 ins. diam. Aluminum cap marked as shown below from which:

A cedar, 7 ins. diam., bears N12°E, 18.40 ft. dist., scribed X BT.

A pine, 8 ins. diam., bears N88°E, 41.30 ft. dist., scribed X BT.

Painted faces and 6 in. wide red bands to all bearing trees and attached Bearing Tree signs.

A steel post bears North 3.00 ft. dist. from set monument with attached Survey Monument decal.

Magnetic declination: 18° East

Equipment used: Hand compass and loggers tape

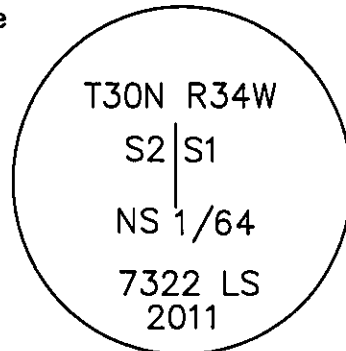

NOTE: Refer to Certificate of Survey No. 4114
Lincoln County Records for additional survey information.

Kootenai Surveyors Inc., 314 California Av., Libby, MT. 59923 (406) 293-4354



Sales 2011

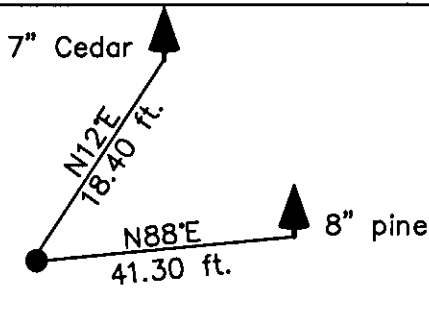

SKETCH OF CORNER

CERTIFICATION

I, Kelly Rooney
certify the information shown herein is true and correct.
Kelly Rooney
Signature Ground Party Chief

I, Alvah F. Hughes
certify that this Corner Record correctly represents work performed by me or under my direction in compliance with the "Corner Recordation Act" (70-22-101, et seq., M.C.A.)
Alvah F. Hughes
Signature of Surveyor & Seal

Date: 11/11/2011 Reg. No. 7322 LS
Employer: Kootenai Surveyors Inc.

Office of Clerk and Recorder, County of Lincoln. This "corner

record" was filed for record on 235961 BOOK: CCR CC&R'S PAGE: 11925 Pages: 1

was noted on the c STATE OF MONTANA LINCOLN COUNTY
book No. RECORDED: 11/16/2011 9:10 KOI: CC&R'S
TAMMY D. LAUER CLERK AND RECORDER
FEE: \$0.00 BY: *Tammy D. Lauer*
TO: KOOTENAI SURVEYORS INC. P.O. BOX 393, LIBBY, MT 59923

Cross Index No. _____ T. 30N R. 34W P.M.M., MT

Adopted July 1, 1981, Montana Board of Professional Engineers & Land Surveyors

Sec. 2

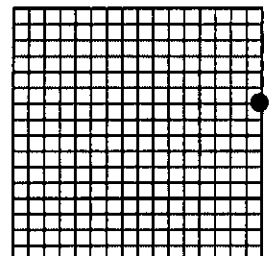

• corner this sheet