

CERTIFIED LAND CORNER RECORDATION

SECTION 32 TWP. 30 N., R. 33 W., M.P.M.

DESCRIPTION OF CORNER EVIDENCE FOUND, AND ORIGINAL RECORD (IF KNOWN)

S.E. Cor. (#1 on reverse) Brass Cap by B.L.M.
 E. $\frac{1}{4}$ Cor. (# 2 on reverse) Not found - Quartzite stone 14"x10"x8" in ground
 Marked $\frac{1}{4}$ on west face, from which a 12" Pine bears S 60°30' E 32 lks.
 Marked $\frac{1}{4}$ S B.T.
 N E. Cor. (#3 on reverse) Brass Cap by B.L.M.
 N $\frac{1}{4}$ Cor. (#4 on reverse) Brass Cap by B.L.M.
 N W Cor. (#6 on reverse) Brass Cap by BL.M.
 W $\frac{1}{4}$ Cor (#7 on reverse) Remains of bearing trees found
 Brass cap subsequently set by B.L.M.
 S W Cor. Brass Cap by B.L.M.
 S $\frac{1}{4}$ Cor. Brass Cap by B.L.M. - moved 66 feet east during progress of this survey-
 as a result of this survey.

DESCRIPTION OF MONUMENT AND ACCESSORIES ESTABLISHED
 TO PERPETUATE THE ORIGINAL LOCATION OF THIS CORNER:

Brass cap monuments set at points indicated on sketch on other side. Date of work August 1968

SKETCH, WITH COURSE AND DISTANCE TO ADJACENT CORNERS IF DETERMINED IN THIS SURVEY.
 (MAY SKETCH OR PASTE REPRODUCTION ON REVERSE SIDE.)

See Other Side

Surveyor's Seal

I, J. H. Ninneman
 certify that the information shown herein is true and correct.

J. H. Ninneman
 Signature of Ground Party Chief

I, J. W. Ninneman 534 E.S.
 certify that I have carefully performed or reviewed the work done on the diagrammed corner as reported on this recordation form and approve the same.

J. W. Ninneman
 Signature of Surveyor 534 E.S.

DIAGRAM OF CORNER:

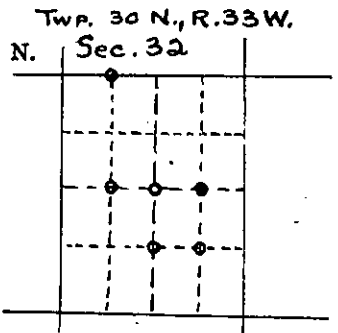

o = Corner recorded on the sheet

Registration Number

Office of Clerk and Recorder, County of Lincoln

This "corner record" was filed for record on the 24th day of September 19 68, was noted on the cross-index plat and is assigned page No. 118, in book No. 1

ELEANOR L. VAUGHN, By: Mae Watson
 County Official Deputy.

Cross Index No. x-6,7,8 T. 30 R. 33 Mer. y-7,8

Cor. # 2 Brass Cap 10" Fir S 36°W 28 Ft. Marked 1/4 & Posted
 12" Fir S 30°E 15.6 Ft. Marked 1/4 & Posted.

Cor.#12 Brass Cap No Bts

Cor.#11 Brass Cap 12" Larch S 80°E 58.4 Ft. Marked 1/16 & Posted

Cor.#10 Brass Cap 12" Fir N 58°W 28.0 Ft 1/16 Posted

Cor.# 9 Brass Cap 26" Pine S 13°E 20 Ft Marked 1/4 Posted

Cor.# 8 Brass Cap 12" Larch N 85°E 26.9 Ft. Marked 1/16 Posted

Cor.# 5 Brass Cap 20" Hemlock S 10°W 24.8 Ft Marked 1/16 Posted

