

CERTIFIED CORNER RECORDATION

Corner 1/4 Cor. S29 S32 T. 30 N., R. 33 W., P.M.M. Lincoln County

Record :

1893 GLO Survey by Daniel Mumbrue.

"Set a quartzite stone 16 x 12 x 6 ins., 11 ins. in the ground for 1/4 Sec. Cor. marked 1/4 on N. face, from which:

A Fir 22 ins. diam. bears N 66 1/2° E, 68 lks. dist., marked 1/4 S29 BT.

A Fir 14 ins. diam. bears S 89° E, 112 lks. dist., marked 1/4 S32 BT."

1965 BLM Remonumentation by D. Lindenberg.

"Set an iron post, 30 ins. long, 2 1/2 ins. diam., 26 ins. in the ground, with brass cap from which:

A Fir 6 ins. diam., bears S. 24° W., 24 lks. dist., mkd. (1/4 S32 BT.)

A Fir 7 ins. diam., bears N. 29° W., 47 lks. dist., mkd. (1/4 S29 BT.)"

Bury the original stone alongside the iron post.

Found Evidence :

At the approximate posititon of the N 1/4 Corner of Section 32, found a 2 1/2 inch diam. steel pipe 30 ins. long, with 3 1/4 inch diam. brass cap marked as shown below, which has been pushed out of the ground by contractors working on gravel pit restoration for the Montana Department of Highways.

A record Douglas Fir (snag) 10 ins. diam., bears N 29° W, 47 lks. (31.02 ft.) dist., with overgrown face.

A record Douglas Fir 11 ins. diam., bears S 24° W, 24 lks. (15.82 ft.) dist., with overgrown face.

Perpetuation :

From the found above mentioned Bearing Trees, we reset from record distances the found BLM brass cap and 30 inch long iron pipe, 26 ins. in the ground, with a collar of stone 2 ft. diam., 6 ins. high around reset monument, from which:

A Douglas Fir 6 1/4 ins. diam. bears N 36°30' W, 22.85 ft. dist., scribed (1/4 S29 BT).

Painted scribed and overgrown faces red with 6 inch wide red bands around all Bearing Trees.

Attached Bearing Tree signs where needed.

Magnetic Declination: 18° East

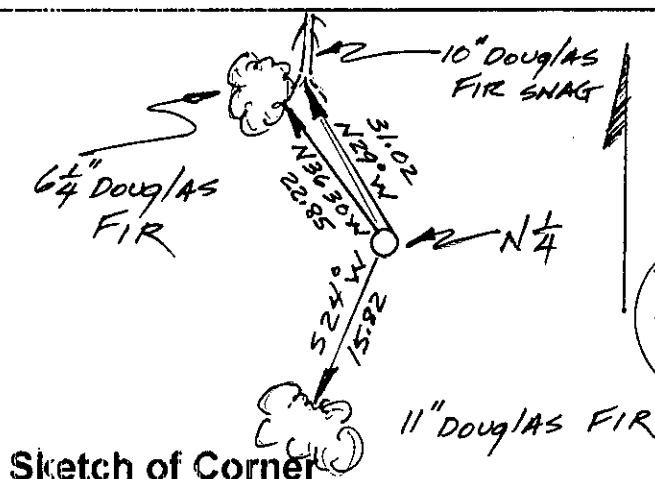

CERTIFICATION

I, John Damon

certify the information shown herein is true and correct

Signature of Ground Party Chief

I, Kenneth E. Davis

certify that this Corner Record correctly represents work performed by me or under my direction in compliance with the "Corner Recoraction Act" (70-22-101, et seq., M.C.A.)

Signature of Surveyor & Seal

Date: 3/11 Reg. No. 4975-S

Employer: Davis Surveying, Inc.

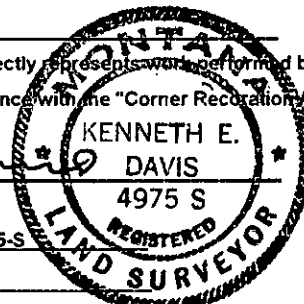

Sketch of Corner

Office of Clerk and Recorder, County of Lincoln.

This "corner record" was filed for record on 3-11-98

was noted on the cross-index plat and is assigned page No. 10076

in book No. Coal M. Cummins By Dep
County Official

Section

SECTION 32

Cross Index No. 1/4 Cor. S29 S32 T. 30 N., R. 33 W., PMM

• THIS CORNER