

CERTIFIED CORNER RECORDATION

Corner N 1/16 Sec. 8 / 9 T. 30N R. 31W P.M., MT Lincoln County

- I. 1974 B.L.M. Dependent Resurvey record by S. B. Hjellum and J. S. Pritchard: At the point for the N 1/16 section corner of sections 8 and 9 set an iron post, 28 ins., long, 2 1/2 ins. diam., 3 ins. below the surface of the ground, with a brass cap mkd:

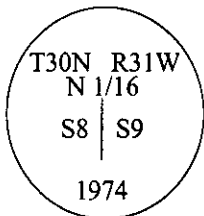

from which:

A fir, 6 ins. diam., bears S60°E, 180 lks dist., mkd. "N 1/16 S9 BT".  
A twin larch, 8 ins. diam., bears S18 3/4°E, 130 lks. dist., mkd. "X BT".

The SW concrete foundation corner of a frame house, bears N60° 02' W, 78 lks. dist.

- II. Found a rebar with a yellow plastic cap mkd. "JHN", 3 ins. below ground surface. (B.L.M. record indicates a brass cap was set).

from which

A fir, 11 ins. diam., bears S60°E, 118.8 ft. (180 lks.) dist., with healed face.  
A twin larch, 12 ins. diam., bears S19°E, 85.8 ft. (130 lks.) dist., with healed face.

The SW corner of house, bears N60°W, 51.5 ft. (78 lks.) dist.

- III. Painted bearing trees and attached Land Survey Monument and Bearing Tree signs.

Magnetic Declination: 20° East.

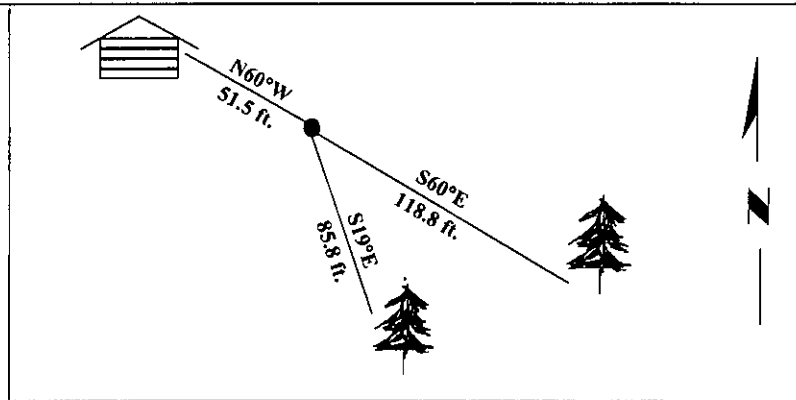

SKETCH OF CORNER

CERTIFICATION

I, Rex O. Rice  
certify the information shown herein is true and correct.

Signature Ground Party Chief

I, Alvah F. Hughes  
certify that this Corner Record correctly represents work performed by me or under my direction in compliance with the "Corner Recordation Act" (70-22-101, et seq., M.G.A.)

Alvah F. Hughes  
Signature of Surveyor Seal

Date: 1/12/96

Reg. No.: 7322LS

Employer: U.S. FOREST SERVICE

Office of Clerk and Recorder, County of LINCOLN. This "corner record" was filed for record on JULY 29, 1997 was noted on the cross-index plat and is assigned page No. 9756 in book No. \_\_\_\_\_

CORAL M. CUMMINGS

County Official

By DER

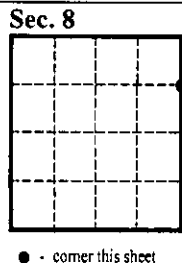

• - corner this sheet