

CERTIFIED CORNER RECORDATION

Corner C 1/4 Sec. 7 T. 30N R. 31W P.M., MT Lincoln County

- I. 1972-74 B.L.M. Record by Shirley B. Hjellum et al.: The center 1/4 sec. cor. of sec. 7, at intersection with the E. and W. center line. Set an iron post, 28 ins. long, 2 1/2 ins. in diam., 4 ins. above the ground, with brass cap mkd. as shown:

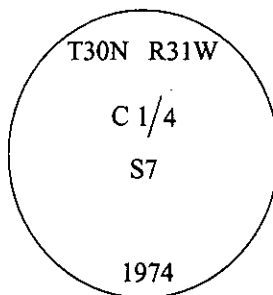

Established two bearing trees:

- A pine, 9 ins. diam., bears N14 3/4°E, 30 lks. dist., mkd. "X" "BT".
A larch, 6 ins. diam., bears N75 1/2°W, 21 lks. dist., mkd. "C1/4 S7 BT".

1986 Certified Corner Recordation Record by Harold W. Grusing-Reg. No. 2925 S. Found a 2 1/2 in. diam. iron post, protruding 4 ins. above the ground, with brass cap mkd. as shown above. Found both original bearing trees.

- II. Found a 2 1/2 in. diam. iron pipe, firmly set, with a 3 1/4 in. diam brass cap, flush with rock collar, mkd. as shown above.

from which:

- A down pine, 11 ins. diam., bears N22°E, 19.8 ft. dist., mkd. "X" "BT". (record N14 3/4°E)
A larch, 9 ins. diam., bears N83°W, 13.8 ft. dist., mkd. with a healed face. (record N75 1/2°W)

- III. Established one new bearing tree:

- A larch, 8 ins. diam., bears N6°E, 9.4 ft. dist., mkd. "X" "BT".

Painted bearing trees and attached Land Survey Monument and Bearing Tree signs.

Magnetic Declination: 20° East.

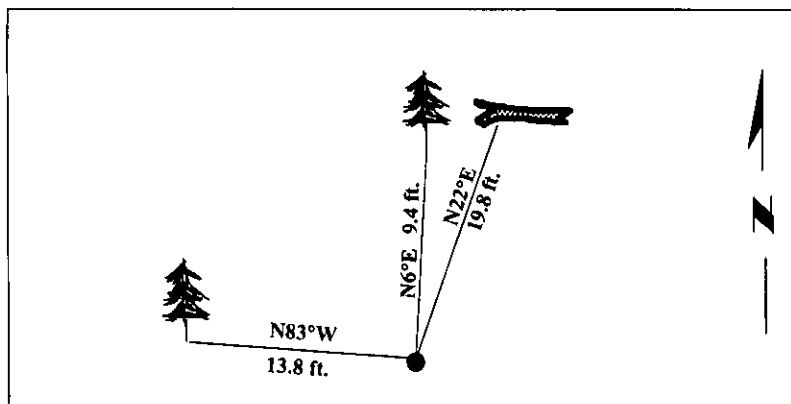

SKETCH OF CORNER

CERTIFICATION

I, Jeffrey A. Hintz
certify the information shown herein is true and correct.

I, Ronald A. Pearson
certify that this Corner Record correctly represents work performed by me or under my direction in compliance with the "Corner Recordation Act" (70-22-101, et seq., M.C.A.)

Signature of Surveyor & Seal

Date: 12/30/96

Reg. No.: 9008LS

Employer: U.S. FOREST SERVICE

Office of Clerk and Recorder, County of LINCOLN. This "corner record" was filed for record on FEB 3, 1997 was noted on the cross-index plat and is assigned page No. 9062 in book No. _____

CORAL M. CUMMINGS

County Official

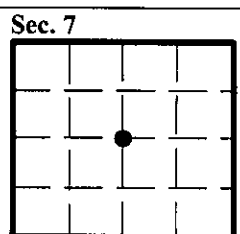

• - corner this sheet