

CERTIFIED CORNER RECORDATION

Corner **SE 1/16** **Sec. 25** **T. 30N** **R. 31W** **P.M., MT** **Lincoln** **County**

I. 1972 B.L.M. Original Record by Shirley B. Hjellum et.al.: Point for the S.E. 1/16 sec. cor. of sec. 25, at intersection with the E. and W. center line of the S.E. 1/4. Set an iron post, 28 ins. long, 2 1/2 ins. in diam., 23 ins. in the ground, with brass cap mkd. as shown:

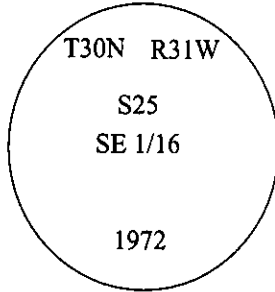

1986 Certified Corner Recordation by Harold W. Grusing No. 2925 S: Found a 2 1/2 in. diam. iron post, protruding 4 ins. above the ground, with the brass cap mkd. as shown above.

from which:

- A stump, 5 ins. diam., bears S68 3/4°E, 58.1 ft. dist., with a fallen log, mkd. "X" "BT". (BLM-record A pine, N68 3/4°E, 88 lks. "58.0 ft.")
- A stump, 6 ins. diam., bears N70 3/4°W, 18.5 ft. dist., mkd. "SE1/16 S25 BT". (BLM-record)

II. Found a 3 in. diam. aluminum pipe, protruding 5 ins. above the ground, with a 3 1/4 in. diam. brass cap mkd. as shown above.

from which:

- A down pine, 9 ins. diam., bears S89°E, 52.7 ft. dist., with no visible scribe.

III. Established two new bearing trees:

- A larch, 9 ins. diam., bears N84°E, 36.2 ft. dist., mkd. "SE 1/16 S25 BT".
- A pine, 17 ins. diam., bears N45°W, 20.1 ft. dist., mkd. "SE 1/16 S25 BT".

Painted bearing trees and attached Land Survey Monument and Bearing Tree signs.

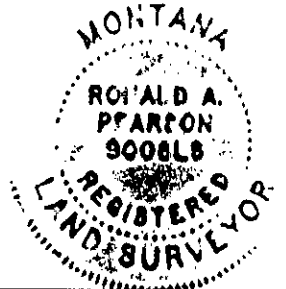

Magnetic Declination: 20° East.

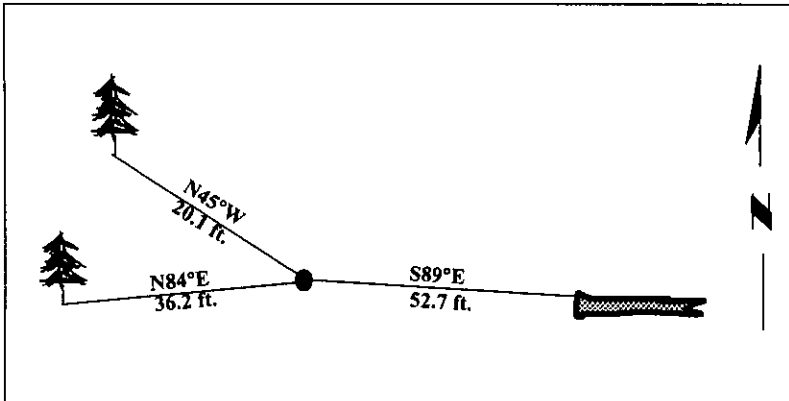

SKETCH OF CORNER

CERTIFICATION

I, Rex O. Rice
 certify the information shown herein is true and correct.

I, Ronald Pearson
 certify that this Corner Record correctly represents work performed by me or under my direction in compliance with the "Corner Recordation Act" (70-22-101, et seq., M.C.A.)

Ronald Pearson
 Signature of Surveyor & Seal

Date: 12/30/96
 Reg. No.: 9008LS
 Employer: U.S. FOREST SERVICE

Office of Clerk and Recorder, County of LINCOLN. This "corner record" was filed for record on FEB 3, 1997 was noted on the cross-index plat and is assigned page No. 9030, in book No. _____

Carol M. [Signature]
 County Official

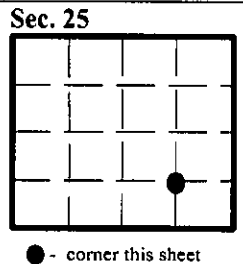

Cross Index No. U-24 T. 30N R. 31W P.M., MT