

CERTIFIED CORNER RECORDATION

Corner 1/4 Sec. 16 & 21 T. 30N R. 31W P.M., MT Lincoln County

I 1894 G.L.O. Original Record by Daniel P. Mumbrue: Set a wooden post, 3 ft. long, 3 ins. square, 24 ins. in the ground, for 1/4 sec. cor., mkd. "1/4 S" on the N. face.

1962 B.L.M. Remonumentation Record by Gerald F. Pittman et. al.: The 1/4 sec. cor. of sec. 16 and 21, as determined from the remains of the two original bearing trees.

from which:

A decayed stump, bears N53°E, 41 lks. dist., mkd. "BT". (record)

A decayed stump, bears S66 1/4°E, 31 lks. dist., mkd. "1/4 S BT". (record)

Set an iron post, 30 ins. long, 2 1/2 ins. diam., 26 ins. in the ground and in a mound of stone, to top, with brass cap mkd. as shown:

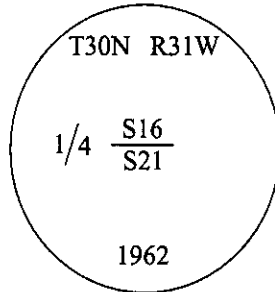

Established two new bearing trees:

A pine, 10 ins. diam., bears S07°E, 32 lks. dist., mkd. "1/4 S21 BT".

A pine, 7 ins. diam., bears N38°W, 35 lks. dist., mkd. "1/4 S16 BT".

1973 B.L.M. Dependent Resurvey by Shirley B. Hjellum et al.: The 1/4 sec. cor. of secs. 16 & 21, monumented with an iron post, 2 1/2 ins. diam., firmly set, protruding 12 ins. above the ground, in a mound of stone, 4 ft. base to top, and witnessed by the GLO and 1962 BLM bearing trees, mkd. as described in their records, with the brass cap mkd. as shown above.

1986 Certified Corner Recordation by Harold W. Grusing No. 2925 S. Found a 2 1/2 in. diam. iron post, protruding 8 ins. above the ground, in a collar of stone, witnessed by the remains of the N.E. GLO and both 1962 bearing trees, mkd. as described in their records, with the brass cap mkd. as shown above.

II. Found a 3 in. diam. steel pipe, protruding 3 ins. above the ground, with a 3 1/4 in. diam. brass cap mkd. as shown above.

from which:

A stump, 15 ins. diam., bears N53°E, 27.7 ft. dist., with no visible scribe. (GLO-record)

A dead pine, 14 ins. diam., bears S07°E, 21.3 ft. dist., mkd. "1/4 S BT". (1962 BLM-record)

A pine, 15 ins. diam., bears N39 1/2°W, 23.6 ft. dist., "no visible scribe" (1962 BLM-record N38°W)

III. Established one new bearing tree:

A fir, 13 ins. diam., bears S15°E, 52.2 ft. dist., mkd. "1/4 S21 BT".

Painted bearing trees and attached Land Survey Monument and Bearing Tree signs.

Magnetic Declination: 20° East.

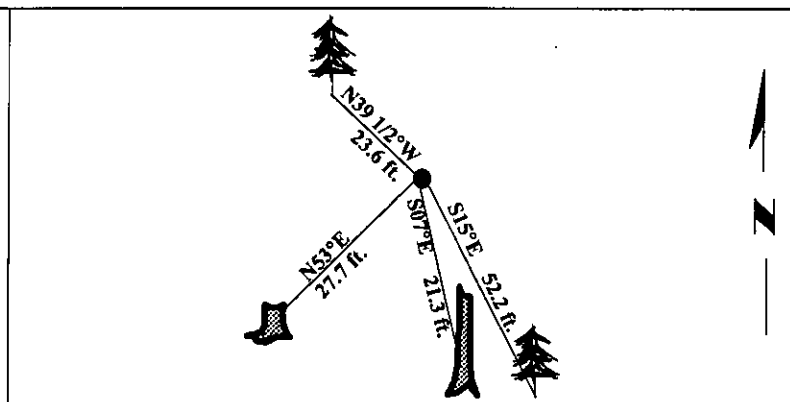

SKETCH OF CORNER

I. Rex O. Rice

certify the information shown herein is true and correct.

I. Ronald A. Pearson

certify that this Corner Record correctly represents work performed by me or under my direction in compliance with the "Corner Recordation Act" (70-22-101, et seq., M.C.A.)

Signature of Surveyor & Seal

Date: 12/30/96

Reg. No.: 9008LS

Employer: U.S. FOREST SERVICE



Office of Clerk and Recorder, County of LINCOLN. This "corner record" was filed for record

on FEB 3, 1997 was noted on the cross-index plat and is assigned page No. 9029,

in book No. _____

County Official

Sec. 21

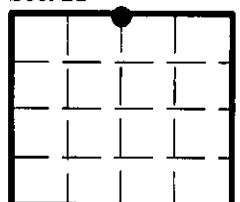

● - corner this sheet

Cross Index No.

N-11

T.

30N

R.

31W

P.M., MT