

CERTIFIED CORNER RECORDATION

Corner 1/4 Sec. 17 & 20 T. 30N R. 31W P.M., MT Lincoln County

I. 1893 G.L.O. Original Record by Daniel P. Mumbroe: Set a wooden post, 3 ft. long, 3 ins. square, 24 ins. in the ground, for 1/4 sec. cor., mkd. "1/4 S" on the N. face. Set two bearing trees.

1962 B.L.M. Remonumentation Record by Gerald F. Pittman et. al.: The 1/4 sec. cor. of secs. 17 and 20, monumented by the remains of a wooden post, 3 ins. square, 18 ins. long, firmly set and witnessed by the remains of the two original bearing trees. from which:

A larch snag, 20 ins. diam., bears S06°W, 22 lks. dist., mkd. "1/4 S BT". (record-S19°W)

A decayed stump, bears N05°W, 41 lks. dist., mkd "1/4 S BT". (record-N08 1/2°W)

At the corner position, set an iron post, 30 ins. long, 2 1/2 ins. in diam., 26 ins. in the ground, with brass cap mkd. as shown:

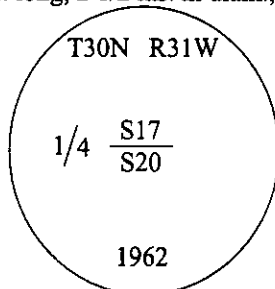

Established two new bearing trees:

A fir, 11 ins. diam., bears N34°E, 33 lks. dist., mkd. "1/4 S17 BT".

A fir, 7 ins. diam., bears S37°E, 29 lks. dist., mkd. "1/4 S20 BT".

Bury the remains of the original wooden post alongside and raise a flat mnd. of stone, 4 ft. diam. around the iron post.

1973 B.L.M. Dependent Resurvey by Shirley B. Hjellum et al.: The 1/4 sec. cor. of secs. 17 & 20, monumented with an iron post, 2 1/2 ins diam., protruding 8 ins. above ground, firmly set, in a collar stone and monumented by the remains of the original and 1962 bearing trees, mkd. as described in the original and 1962 records, with the brass cap mkd. as shown above.

1986 Certified Corner Recordation by Harold W. Grusing No. 2925 S. Found a 2 1/2 in. diam. iron post, protruding 4 ins. above the ground, in a collar of stone and witnessed by one original and both 1962 bearing trees, mkd. as described in the original and 1962 records, with the brass cap mkd. as shown above.

II. Found a 3 in. diam. aluminum pipe, protruding 3 ins. above the ground, with a small collar of stone, firmly set, with a 3 1/4 in. diam. brass cap mkd. as shown above.

from which:

A fir, 16 ins. diam., bears N34°E, 22.2 ft. dist., mkd. with a healed face. (1962-record 33 lks. "21.1 ft.")

A down fir, 12 ins. diam., bears S27°E, 19.3 ft. dist., "healed face." (1962.)

A stump with a tree laying alongside, bears S11°W, 13.7 ft. dist., mkd. "BT" visible. (GLO-record S19°W, 22 lks. "14.5 ft.")

III. Established one new bearing tree.

A fir, 8 ins. diam., bears S84°E, 18.6 ft. dist., mkd. "1/4 S20 BT".

Painted bearing trees and attached Land Survey Monument and Bearing Tree signs.

Magnetic Declination: 20° East.

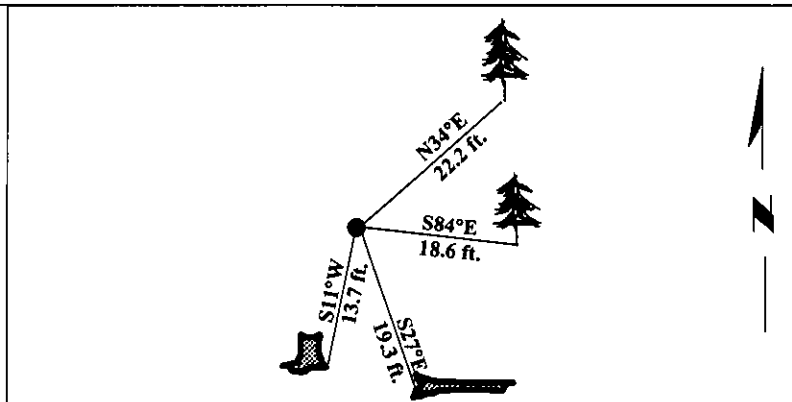

SKETCH OF CORNER

CERTIFICATION

I, Rex O. Rice
certify the information shown herein is true and correct.

I, Ronald A. Pearson
certify that this Corner Record correctly represents work performed by me or under my direction in compliance with the "Corner Recordation Act" (70-22-101, et seq., M.C.A.)

Signature of Surveyor & Seal

Date: 12/30/96

Reg. No.: 9008LS

Employer: U.S. FOREST SERVICE

Office of Clerk and Recorder, County LINCOLN. This "corner record" was filed for record on FEB 3, 1997 was noted on the cross index plat and is assigned page No. 9026, in book No. CORAL MCGINNIS By RLB

County Official

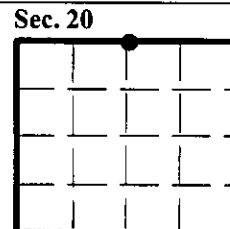

Cross Index No. N-07 T. 30N R. 31W P.M., MT